

COUNTY OF HAWAII STATE OF HAWAII

BILL NO. 316

ORDINANCE NO. 00 126

AN ORDINANCE AMENDING THE STATE LAND USE BOUNDARIES MAP, H-66 FOR THE COUNTY OF HAWAII, BY CHANGING THE DISTRICT CLASSIFICATION FROM THE AGRICULTURAL TO THE URBAN DISTRICT AT WAIAKEA, SOUTH HILO, HAWAII, COVERED BY TAX MAP KEY 2-4-35 25

BE IT ORDAINED BY THE COUNCIL OF THE COUNTY OF HAWAII

SECTION 1 The State Land Use Boundaries Map, H-66 for the County of Hawaii, is amended to change the district classification of property described hereinafter as follows

The district classification of the following area situated at Waiakea, South Hilo, Hawaii, shall be Urban

LAND SITUATED AT WAIAKEA, SOUTH HILO, ISLAND OF HAWAII, HAWAII

Being a portion of Grant 10,594 to Oteru Takehiro Koshiyama, being also a portion of Lot B, Waiakea Homesteads, 2nd Series

Beginning at the northeast corner of this parcel of land, being also the northwest corner of Lot B-2 and on the south side of Roadway Lot A, the coordinates of said point of beginning referred to Government Survey Triangulation Station "HALAI", being 17,549 61 feet South and 3,574 62 feet West, thence running by azimuths measured clockwise from true South

- | | | | |
|---|----------|-------------|--|
| 1 | 355° 40' | 177 00 feet | along the remainder of Grant 10,594 to Oteru Takehiro Koshiyama (Lot B-2), |
| 2 | 85° 40' | 249 50 feet | along the remainder of Grant 10,594 to Oteru Takehiro Koshiyama (Lot B-5), |
| 3 | 175° 40' | 157 00 feet | along the remainder of Grant 10,594 to Oteru Takehiro Koshiyama (Lot B-4), |

- 4 265° 40' 25 00 feet along the remainder of Grant 10,594 to Oteru Takehiro Koshiyama (Roadway Lot A),
- 5 Thence along same on a curve to the right with a radius of 20 00 feet, the chord azimuth and distance being 220° 40' 28 28 feet,
- 6 265° 40' 204 50 feet along the remainder of Grant 10,594 to Oteru Takehiro Koshiyama (Roadway Lot A) to the point of beginning and containing an area of 43,576 Square Feet

All as shown on the map attached hereto, marked Exhibit "A" and by reference made a part hereof

SECTION 2 In the event that any portion of this ordinance is declared invalid, such invalidity shall not affect the other parts of this ordinance

SECTION 3 This ordinance shall take effect upon its approval

INTRODUCED BY

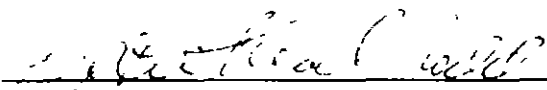

 COUNCIL MEMBER, COUNTY OF HAWAII

Hilo, Hawaii

Date of Introduction October 18, 2000
 Date of 1st Reading October 18, 2000
 Date of 2nd Reading November 9, 2000
 Effective Date November 24, 2000

REFERENCE: Comm. 918

APPROVED AS TO FORM AND LEGALITY

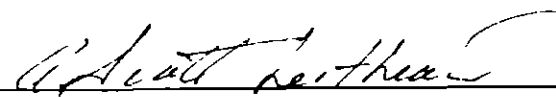

 CORPORATION COUNSEL
 DATED 11/21/00

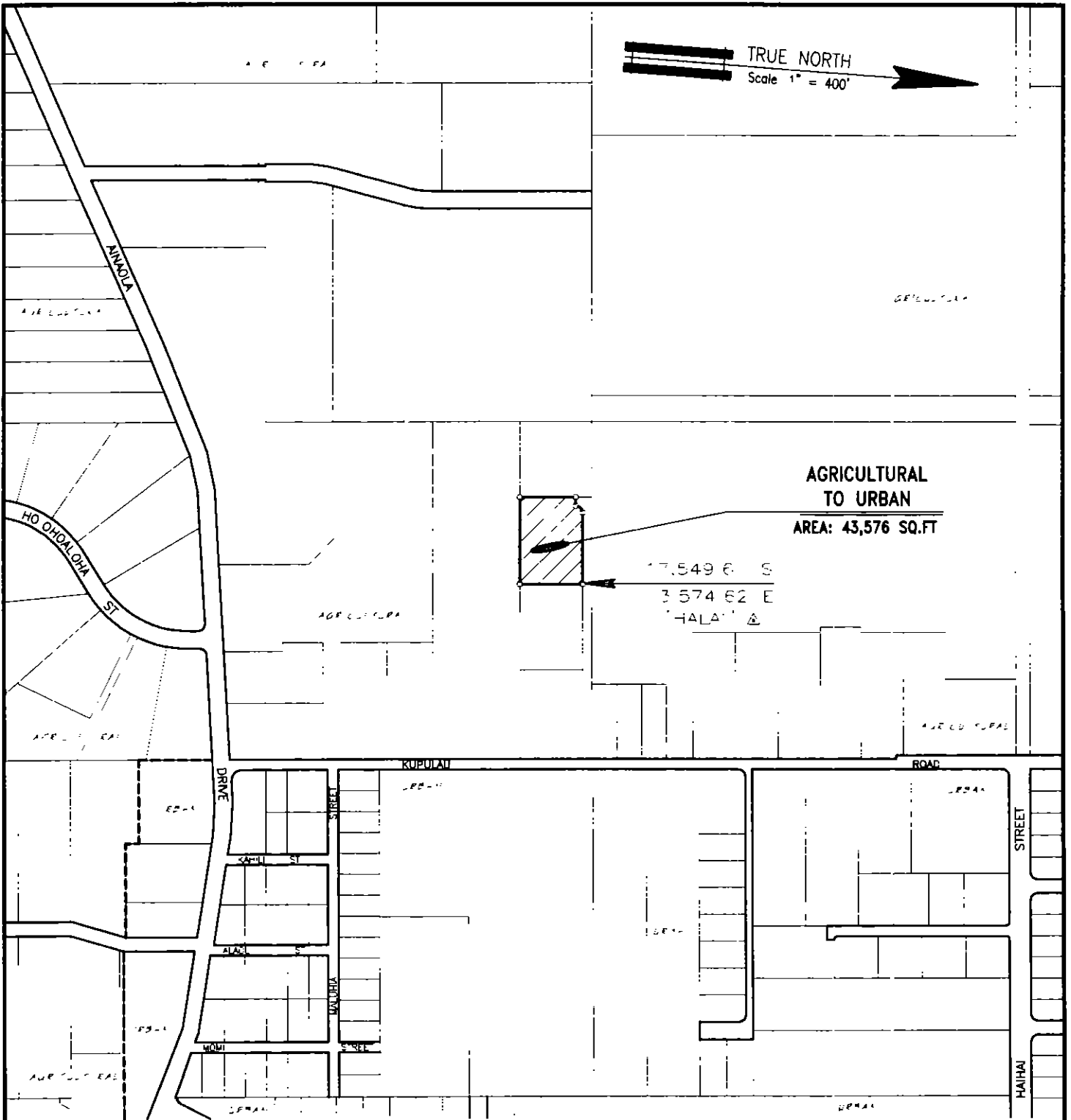
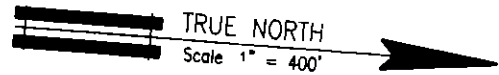

AMENDMENT TO THE STATE LAND USE BOUNDARIES MAP

AMENDING THE STATE LAND USE BOUNDARIES MAP, H-7, FOR THE COUNTY OF HAWAII, BY CHANGING THE DISTRICT CLASSIFICATION FROM THE AGRICULTURAL TO THE URBAN DISTRICT AT KALAOA 4TH, NORTH KONA, HAWAII.

PREPARED BY : PLANNING DEPARTMENT
COUNTY OF HAWAII



OFFICE OF THE COUNTY CLERK
County of Hawaii
File _____, Hawaii

Introduced By Bobby Jean Leithead-Todd
Date Introduced October 18, 2000
First Reading October 19, 2000
Published N/A

REMARKS _____

Second Reading November 17, 2000
To Mayor November 15, 2000
Returned November 24, 2000
Effective November 24, 2000
Published December 4, 2000

REMARKS _____

ROLL CALL VOTE				
	AYES	NOES	ABS	EX
Arakaki	X			
Chung			X	
Flarionoff	X			
Jacobson	X			
Leithead-Todd	X			
Pisicchio	X			
Smith	X			
Tyler	X			
Yagong			X	
	7	0	2	0

ROLL CALL VOTE				
	AYES	NOES	ABS	EX
Arakaki	X			
Chung			X	
Flarionoff	X			
Jacobson	X			
Leithead-Todd	X			
Pisicchio		X		
Smith	X			
Tyler		X		
Yagong			X	
	5	2	2	0

I DO HEREBY CERTIFY that the foregoing Bill was adopted by the County Council published as indicated above

APPROVED AS TO
FORM AND LEGALITY

Bobby Jean Leithead-Todd
DEPUTY CORPORATION COUNSEL
COUNTY OF HAWAII

Date 11/20/00

John C. ...
COUNCIL CHAIRMAN
[Signature]
COUNTY CLERK

Approved ~~Disapproved~~ this 24 day
of November 2000

Herb Yamashiro
MAYOR COUNTY OF HAWAII

Bill No 316
Reference C-918/EC-116
Ord No 00 126