



COUNTY OF HAWAII STATE OF HAWAII

BILL NO. 344

ORDINANCE NO. 00 153

AN ORDINANCE AMENDING THE STATE LAND USE BOUNDARIES MAP, H-14 FOR THE COUNTY OF HAWAII, BY CHANGING THE DISTRICT CLASSIFICATION FROM THE AGRICULTURAL TO THE RURAL DISTRICT AT OULI, SOUTH KOHALA, HAWAII, COVERED BY TAX MAP KEY 6-2-11:28.

BE IT ORDAINED BY THE COUNCIL OF THE COUNTY OF HAWAII:

SECTION 1. The State Land Use Boundaries Map, H-14 for the County of Hawaii, is amended to change the district classification of property described hereinafter as follows:

The district classification of the following area situated at Ouli, South Kohala, Hawaii, shall be Rural:

Beginning at the north corner of this parcel of land, being the east corner of Lot 29 and on the southwesterly side of Easement "22" (for road and utility purposes), being a portion of Lot 30, the coordinates of said point of beginning referred to Government Survey Triangulation Station "PUU PA" being 10,803.21 feet north and 17,773.84 feet west, thence running by azimuths measured clockwise from true South:

- 1. Following along Easement "22" (for road and utility purposes), being a portion of Lot 30, along a curve to the left with a radius of 45.00 feet, the chord azimuth and distance being:

298° 59' 46.69

- 2. 357° 44' 576.19 feet along Lot 27 to the middle of Keanuiomano Stream;

Thence following along the middle of Keanuiomano Stream, with all its windings, the direct azimuths and distances for the next three (3) courses being:

- 3. 74° 06' 10" 9.02 feet to a "+" on boulder;

- 4. 81° 23' 30" 245.47 feet to a "+" on boulder;

- | | | | |
|----|--------------|--------|---|
| 5. | 76° 58' 20" | 159.86 | feet; |
| 6. | 164° 06' 48" | 325.33 | feet along Lot 4, portion of Royal Patent 2237, Land Commission Award 8518-B, Apana 1 to James Young Kanehoa; |
| 7. | 230° 10' 30" | 563.21 | feet along Lot 29 to the point of beginning and containing an area of 5.002 acres, more or less. |

All as shown on the map attached hereto, marked Exhibit "A" and by reference made a part hereof.

SECTION 2. In the event that any portion of this ordinance is declared invalid, such invalidity shall not affect the other parts of this ordinance.

SECTION 3. This ordinance shall take effect upon its approval.

INTRODUCED BY:



 COUNCIL MEMBER, COUNTY OF HAWAII

Hilo, Hawaii

Date of Introduction: November 29, 2000
 Date of 1st Reading: November 29, 2000
 Date of 2nd Reading: December 20, 2000
 Effective Date: December 26, 2000

REFERENCE: Comm. 969

APPROVED AS TO FORM AND LEGALITY



 CORPORATION COUNSEL
 DATED: 12-22-00

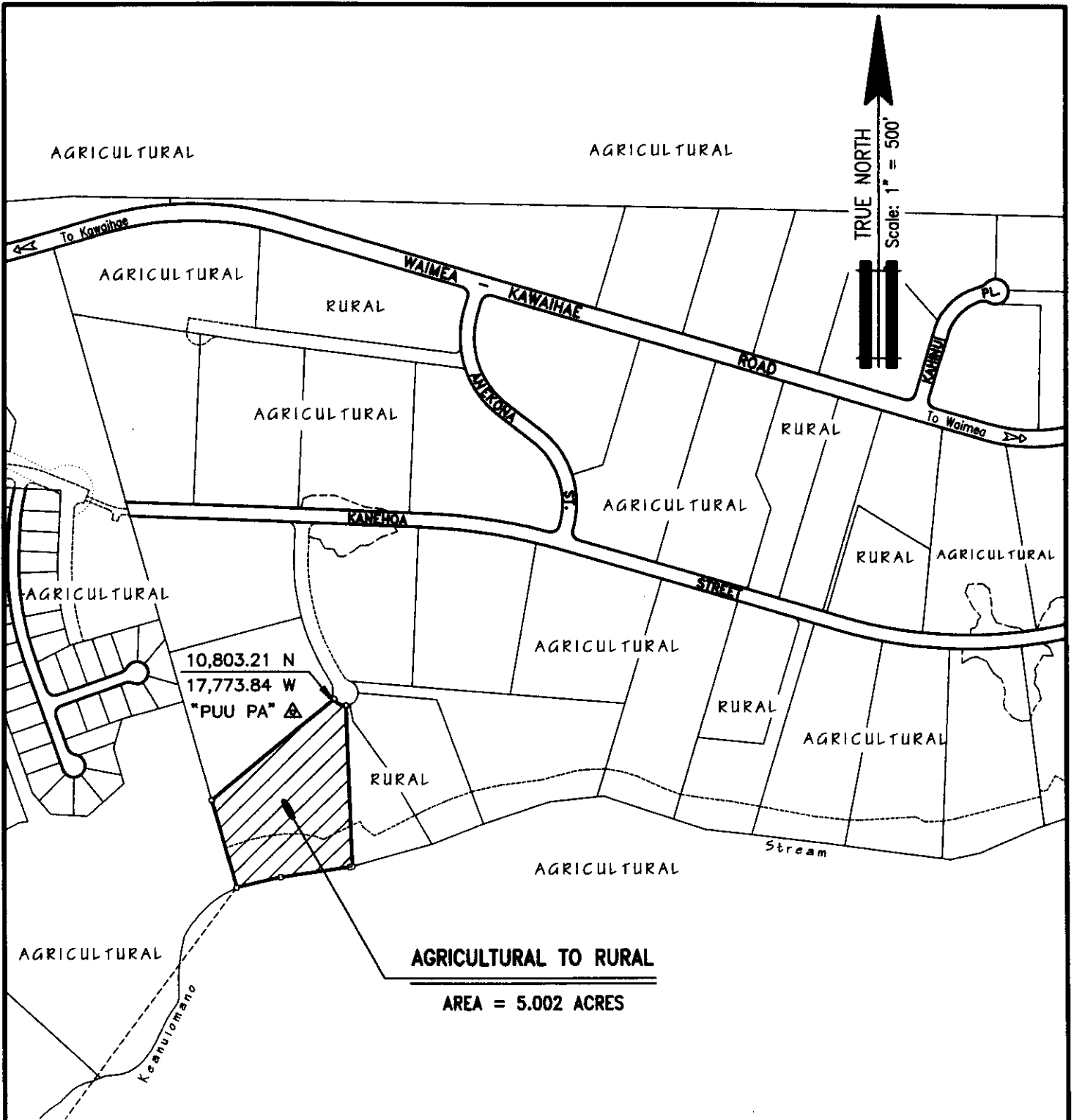

AMENDMENT TO THE STATE LAND USE BOUNDARIES MAP

AMENDING THE STATE LAND USE BOUNDARIES MAP, H-14, FOR THE COUNTY OF HAWAII, BY CHANGING THE DISTRICT CLASSIFICATION FROM THE AGRICULTURAL TO THE RURAL DISTRICT AT OULI, SOUTH KOHALA, HAWAII.

PREPARED BY: PLANNING DEPARTMENT
COUNTY OF HAWAII

OFFICE OF THE COUNTY CLERK
 County of Hawaii
 Hilo, Hawaii

RECEIVED

Introduced By: Bobby Jean Leithead-Todd (B/R)
 Date Introduced: November 29, 2000
 First Reading: November 29, 2000
 Published: N/A

REMARKS: _____

Second Reading: December 20, 2000
 To Mayor: December 21, 2000
 Returned: December 26, 2000
 Effective: December 26, 2000
 Published: January 8, 2001

REMARKS: _____

00 DEC 26 11 23

ROLL CALL VOTE				
	AYES	NOES	ABS	EX
Arakaki	X			
Chung	X			
Elarionoff	X			
Jacobson		X		
Leithead-Todd			X	
Pisicchio	X			
Smith	X			
Tyler	X			
Yagong	X			
	7	1	1	0

ROLL CALL VOTE				
	AYES	NOES	ABS	EX
Arakaki	X			
Chung			X	
Elarionoff	X			
Jacobson		X		
Leithead-Todd	X			
Pisicchio	X			
Safarik	X			
Tyler	X			
Yagong	X			
	7	1	1	0

I DO HEREBY CERTIFY that the foregoing BILL was adopted by the County Council published as indicated above.

APPROVED AS TO
 FORM AND LEGALITY:

 DEPUTY CORPORATION COUNSEL
 COUNTY OF HAWAII

Date 12-22-00

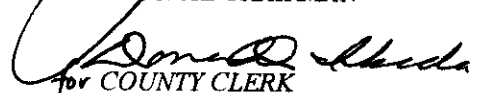
 COUNCIL CHAIRMAN

 for COUNTY CLERK

Approved Disapproved this 26th day
 of December, 2000

 MAYOR, COUNTY OF HAWAII

Bill No.: 344
 Reference: C-969/PC-120
 Ord. No.: 00 153