

COUNTY OF HAWAII STATE OF HAWAII



BILL NO. 346

ORDINANCE NO. 00 154

AN ORDINANCE AMENDING THE STATE LAND USE BOUNDARIES MAP, H-25 FOR THE COUNTY OF HAWAII, BY CHANGING THE DISTRICT CLASSIFICATION FROM THE AGRICULTURAL TO THE RURAL DISTRICT AT OULI, SOUTH KOHALA, HAWAII, COVERED BY TAX MAP KEY 6-2-9:22.

BE IT ORDAINED BY THE COUNCIL OF THE COUNTY OF HAWAII:

SECTION 1. The State Land Use Boundaries Map, H-25 for the County of Hawaii, is amended to change the district classification of property described hereinafter as follows:

The district classification of the following area situated at Ouli, South Kohala, Hawaii, shall be Rural:

Beginning at the Northeasterly corner of this parcel of land, being also the Northwesterly corner of Lot 20 of Kanehoa Subdivision (File Plan 1845) and being a point on the Southerly side of Lot 30 (Roadway) of Kanehoa Subdivision (File Plan 1845), the coordinates of said point of beginning referred to Government Survey Triangulation Station "PUU PA" being 11,329.15 feet North and 12,884.46 feet West and running by azimuths measured clockwise from True South:

- 1. 9° 52' 815.56 feet along Lot 20 of Kanehoa Subdivision (File Plan 1845) and along the remainder of Royal Patent 2237, Land Commission Award 8518-B, Apana 1 to James Young Kanehoa to a point;

Thence, for the next two (2) courses following along the middle of Keanuiomano Stream, in all of its meanderings, the direct azimuths and distances being:

- 2. 91° 48' 03" 178.18 feet along Government Land (State of Hawaii) to a point;

- | | | | |
|----|----------|--------|--|
| 3. | 61° 19' | 151.65 | feet along Government Land (State of Hawaii) to a point; |
| 4. | 189° 52' | 971.69 | feet along Lots 26 and 25 of Kanehoa Subdivision (File Plan 1845) and along the remainder of Royal Patent 2237, Land Commission Award 8518-B, Apana 1 to James Young Kanehoa to a point; |

Thence, for the next three (3) courses following along the Southerly side of Lot 30 (Roadway) of Kanehoa Subdivision (File Plan 1845):

- | | | | |
|----|----------|-------|------------------|
| 5. | 297° 00' | 99.11 | feet to a point; |
|----|----------|-------|------------------|

Thence, following on a curve to the left with a radius of 350.00 feet, the chord azimuth and distance being:

- | | | | |
|----|--------------|--------|---|
| 6. | 285° 30' 50" | 139.39 | feet to a point; |
| 7. | 274° 01' 40" | 61.91 | feet to the point of beginning and containing an area of 5.821 Acres. |

All as shown on the map attached hereto, marked Exhibit "A" and by reference made a part hereof.

SECTION 2. In the event that any portion of this ordinance is declared invalid, such invalidity shall not affect the other parts of this ordinance.

SECTION 3. This ordinance shall take effect upon its approval.

INTRODUCED BY:

COUNCIL MEMBER, COUNTY OF HAWAII

Hilo, Hawaii

Date of Introduction: November 29, 2000
Date of 1st Reading: November 29, 2000
Date of 2nd Reading: December 20, 2000
Effective Date: December 26, 2000

REFERENCE: Comm. 970

APPROVED AS TO FORM AND LEGALITY

CORPORATION COUNSEL
DATED: 12 - 22 - 00

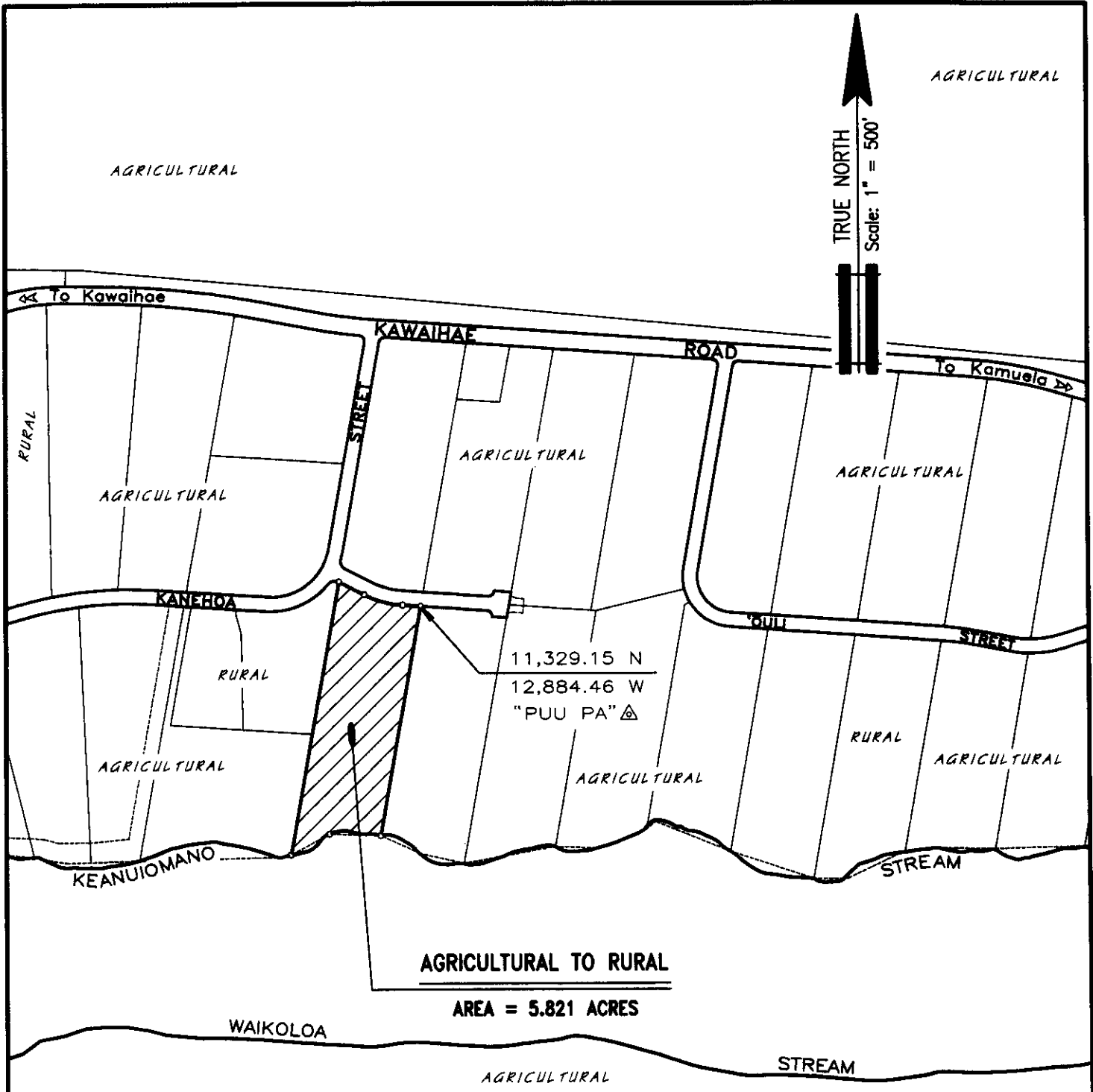

AMENDMENT TO THE STATE LAND USE BOUNDARIES MAP

AMENDING THE STATE LAND USE BOUNDARIES MAP, H-25, FOR THE COUNTY OF HAWAII, BY CHANGING THE DISTRICT CLASSIFICATION FROM THE AGRICULTURAL TO THE RURAL DISTRICT AT OULI, SOUTH KOHALA, HAWAII.

PREPARED BY: PLANNING DEPARTMENT
COUNTY OF HAWAII



OFFICE OF THE COUNTY CLERK

County of Hawaii

Hilo, Hawaii

Introduced By: Bobby Jean Leithead-Todd (B/R)
 Date Introduced: November 29, 2000
 First Reading: November 29, 2000
 Published: N/A

REMARKS: _____

Second Reading: December 20, 2000
 To Mayor: December 21, 2000
 Returned: December 26, 2000
 Effective: December 26, 2000
 Published: January 8, 2001

REMARKS: _____

RECEIVED

ROLL CALL VOTE				
	AYES	NOES	ABS	EX
Arakaki	X			
Chung	X			
Elarionoff	X			
Jacobson		X		
Leithead-Todd			X	
Pisicchio	X			
Smith	X			
Tyler	X			
Yagong	X			
	7	1	1	0



ROLL CALL VOTE				
	AYES	NOES	ABS	EX
Arakaki	X			
Chung			X	
Elarionoff	X			
Jacobson		X		
Leithead-Todd	X			
Pisicchio	X			
Safarik	X			
Tyler	X			
Yagong	X			
	7	1	1	0

I DO HEREBY CERTIFY that the foregoing BILL was adopted by the County Council published as indicated above.

APPROVED AS TO
FORM AND LEGALITY:

 DEPUTY CORPORATION COUNSEL
 COUNTY OF HAWAII

Date 12-22-00

 COUNCIL CHAIRMAN

 for COUNTY CLERK

Approved Disapproved this 26th day
 of December, 2000.

 MAYOR, COUNTY OF HAWAII

Bill No.: 346
 Reference: C-970/PC-122
 Ord. No.: 00 154