

COUNTY OF HAWAII . STATE OF HAWAII

BILL NO. 9

ORDINANCE NO. 01 14

AN ORDINANCE AMENDING THE STATE LAND USE BOUNDARIES MAP, H-8 FOR THE COUNTY OF HAWAII, BY CHANGING THE DISTRICT CLASSIFICATION FROM THE AGRICULTURAL TO THE URBAN DISTRICT AT KEAUKOU 1ST, NORTH KONA, HAWAII, COVERED BY TAX MAP KEY 7-8-11-9

BE IT ORDAINED BY THE COUNCIL OF THE COUNTY OF HAWAII

SECTION 1 The State Land Use Boundaries Map, H-8 for the County of Hawaii, is amended to change the district classification of property described hereinafter as follows:

The district classification of the following area situated at Keauhou 1st, North Kona, Hawaii, shall be Urban

Beginning at a 1/2 inch pipe at the Southwesterly corner of this parcel of land, being also the Northwesterly corner of Lot 1-A and being a point on the Easterly boundary of Lot 5-A, the coordinates of said point of beginning referred to Government Survey Triangulation Station "KEAUKOU COAST" being 4,465.69 feet North and 3,706.82 feet East and running by azimuths measured clockwise from True South:

1. 163° 21' 30" 426.15 feet along Lot 5-A and along Royal Patent 4475, Land Commission Award 7713, Apana 7 to V Kamamalu to a point,
2. 253° 54' 30" 729.98 feet along Lots 8, 9, 10 and 18 of Keauhou Estates, Phase III (File Plan 2137) (aka Bayview Estates) and along Land Commission Award 9697, Apana 2 to Nauki to a point,

- | | | | |
|---|-------------|--------|---|
| 3 | 5° 31' 30" | 174 20 | feet along Lot 1-B and along Land Commission Award 9701 to Apea to a ½ inch pipe, |
| 4 | 52° 08' 40" | 712 50 | feet along Lots 1-B and 1-A and along Land Commission Award 7327 to Keohulu to the point of beginning and containing an area of 4 606 Acres |

All as shown on the map attached hereto, marked Exhibit "A" and by reference made a part hereof

SECTION 2 In the event that any portion of this ordinance is declared invalid, such invalidity shall not affect the other parts of this ordinance

SECTION 3 This ordinance shall take effect upon its approval.

INTRODUCED BY:

By Richard Todd (BR)
COUNCIL MEMBER, COUNTY OF HAWAII

Hilo, Hawaii

Date of Introduction. January 10, 2001
Date of 1st Reading: January 10, 2001
Date of 2nd Reading: January 24, 2001
Effective Date February 6, 2001

REFERENCE: Comm. 18

APPROVED AS TO FORM AND LEGALITY

Deputy C. Scott Keith
CORPORATION COUNSEL
DATED: 2/5/01

TRUE NORTH
Scale 1" = 400'

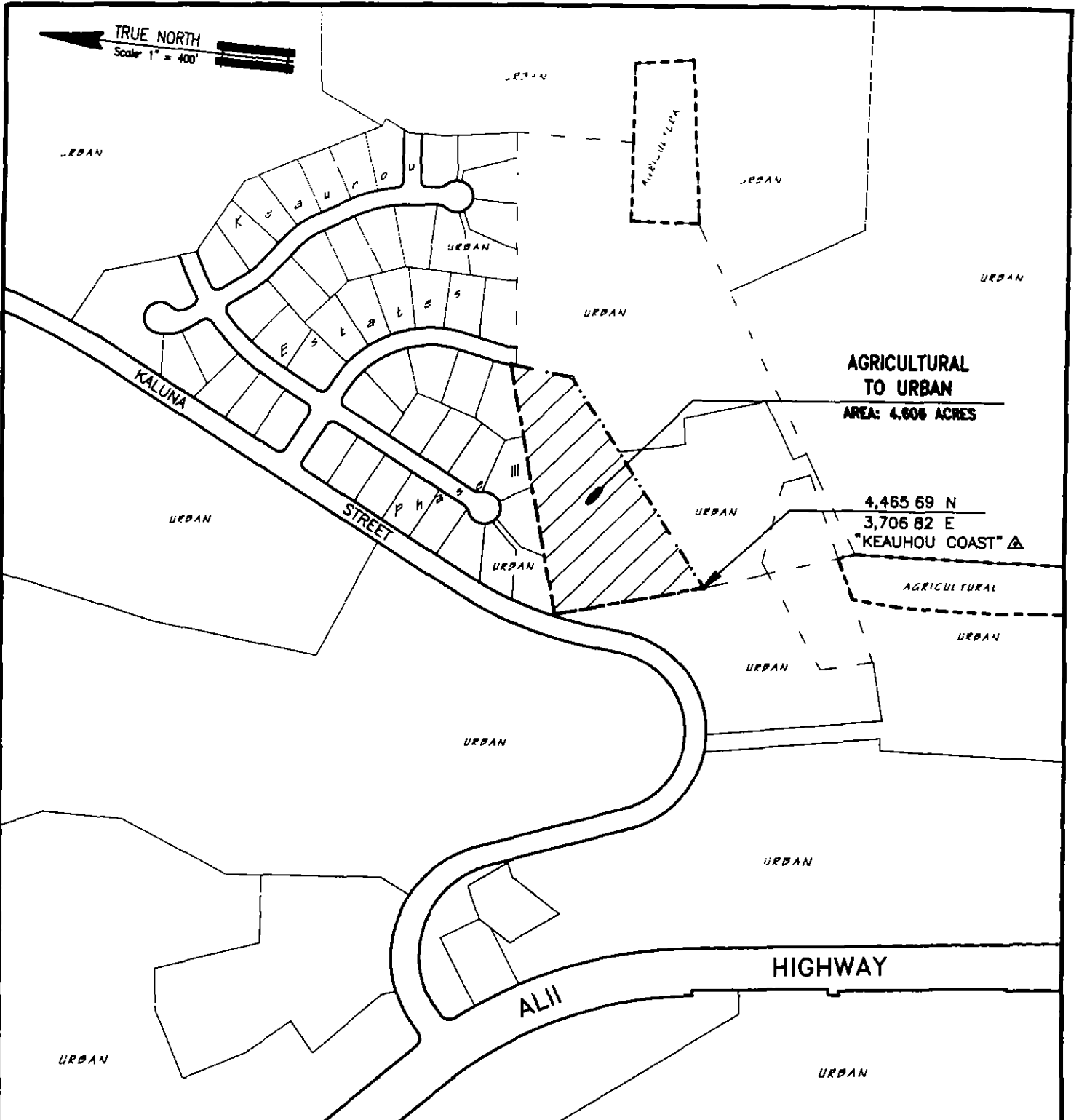

AMENDMENT TO THE STATE LAND USE BOUNDARIES MAP

AMENDING THE STATE LAND USE BOUNDARIES MAP, H-8, FOR THE COUNTY OF HAWAII, BY CHANGING THE DISTRICT CLASSIFICATION FROM THE AGRICULTURAL TO THE URBAN DISTRICT AT KEAUHOU 1ST, NORTH KONA, HAWAII.

PREPARED BY : PLANNING DEPARTMENT
COUNTY OF HAWAII



OFFICE OF THE COUNTY CLERK
County of Hawaii
Hilo, Hawaii

Introduced By: Bobby Jean Leithead-Todd (B/R)
Date Introduced January 10, 2001
First Reading January 10, 2001
Published N/A

REMARKS _____

Second Reading January 24, 2001
To Mayor January 26, 2001
Returned February 6, 2001
Effective February 6, 2001
Published February 20, 2001

REMARKS _____

ROLL CALL VOTE				
	AYES	NOES	ABS	EX
Arakaki	X			
Chung	X			
Elarionoff	X			
Jacobson		X		
Leithead-Todd	X			
Pisicchio			X	
Safarik	X			
Tyler	X			
Yagong			X	
	6	1	2	0



ROLL CALL VOTE				
	AYES	NOES	ABS	EX
Arakaki	X			
Chung	X			
Elarionoff	X			
Jacobson		X		
Leithead-Todd	X			
Pisicchio	X			
Safarik	X			
Tyler	X			
Yagong			X	
	7	1	1	0

I DO HEREBY CERTIFY that the foregoing BILL was adopted by the County Council published as indicated above

APPROVED AS TO
FORM AND LEGALITY:

DEPUTY CORPORATION COUNSEL
COUNTY OF HAWAII

Date 2/5/01

COUNCIL CHAIRMAN

COUNTY CLERK

Approved/Disapproved this 5th day
of February, 2001

MAYOR, COUNTY OF HAWAII

Bill No 9
Reference C-18/PC-3
Ord No 01 14