

COUNTY OF HAWAII STATE OF HAWAII

BILL NO. 45

ORDINANCE NO. 01 46

AN ORDINANCE AMENDING THE STATE LAND USE BOUNDARIES MAP, H-8 FOR THE COUNTY OF HAWAII, BY CHANGING THE DISTRICT CLASSIFICATION FROM THE AGRICULTURAL TO THE URBAN DISTRICT AT KEAUHOU 1ST, NORTH KONA, HAWAII, COVERED BY TAX MAP KEY 7-8-11:PORTION OF 8.

BE IT ORDAINED BY THE COUNCIL OF THE COUNTY OF HAWAII:

SECTION 1. The State Land Use Boundaries Map, H-8 for the County of Hawaii, is amended to change the district classification of property described hereinafter as follows:

The district classification of the following area situated at Keauhou 1st, North Kona, Hawaii, shall be Urban:

Beginning at a 3/4 inch pipe at the Southwesterly corner of this parcel of land, being also the Southeasterly corner of Lot 1-B, the coordinates of said point of beginning referred to Government Survey Triangulation Station "KEAUHOU COAST" being 4,598.35 feet North and 4,747.37 feet East and running by azimuths measured clockwise from True South:

- 1. 176° 03' 15" 192.83 feet along Lot 1-B and along Royal Patent 4475, Land Commission Award 7713, Apana 7 to V. Kamamalu to a 3/4 inch pipe;
2. 265° 11' 30" 238.48 feet along Lot 1-B and along Royal Patent 4475, Land Commission Award 7713, Apana 7 to V. Kamamalu to a point;

Thence, for the next five (5) courses following along the remainder of Land Commission Award 10258, Apana 3 to Maikai:

- 3. 00° 43' 17.50 feet along Westerly face of stonewall to a point;
4. 353° 38' 63.20 feet to a point;

- | | | | |
|----|-------------|--------|--|
| 5. | 43° 10' | 19.30 | feet along Westerly face of stonewall to a point; |
| 6. | 359° 43' | 26.00 | feet to a point; |
| 7. | 358° 12' | 62.10 | feet partially along Westerly face of stonewall to a point; |
| 8. | 82° 15' 32" | 222.06 | feet along stonewall and along Royal Patent 4475, Land Commission Award 7713, Apana 7 to V. Kamamalu to the point of beginning and containing an area of 43,107 Square Feet or 0.990 Acre. |

All as shown on the map attached hereto, marked Exhibit "A" and by reference made a part hereof.

SECTION 2. In the event that any portion of this ordinance is declared invalid, such invalidity shall not affect the other parts of this ordinance.

SECTION 3. This ordinance shall take effect upon its approval.

INTRODUCED BY:



 COUNCIL MEMBER, COUNTY OF HAWAII

Hilo, Hawaii

Date of Introduction: April 18, 2001

Date of 1st Reading: April 18, 2001

Date of 2nd Reading: May 2, 2001

Effective Date: May 9, 2001

REFERENCE: Comm. 159

APPROVED AS TO FORM AND LEGALITY

 CORPORATION COUNSEL
 DATED: _____

TRUE NORTH
Scale: 1" = 400'

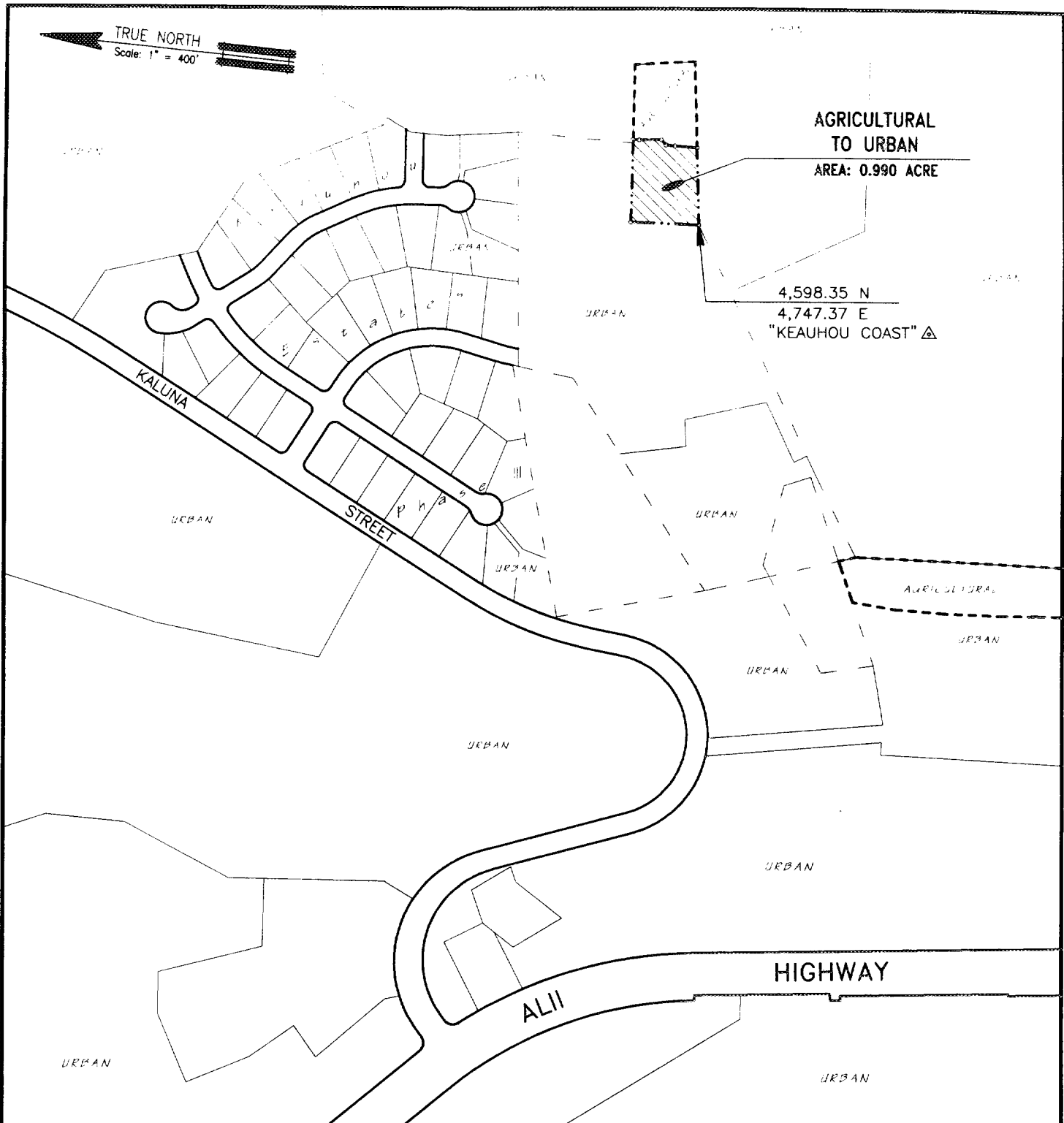

AMENDMENT TO THE STATE LAND USE BOUNDARIES MAP

AMENDING THE STATE LAND USE BOUNDARIES MAP, H-8, FOR THE COUNTY OF HAWAII, BY CHANGING THE DISTRICT CLASSIFICATION FROM THE AGRICULTURAL TO THE URBAN DISTRICT AT KEAUHOU 1ST, NORTH KONA, HAWAII.

PREPARED BY : PLANNING DEPARTMENT
COUNTY OF HAWAII



OFFICE OF THE COUNTY CLERK
County of Hawaii
Hilo, Hawaii

Introduced By: Bobby Jean Leithead-Todd
Date Introduced: April 18, 2001
First Reading: April 18, 2001
Published: April 18, 2001

REMARKS: _____

Second Reading: May 2, 2001
To Mayor: May 7, 2001
Returned: May 10, 2001
Effective: May 9, 2001
Published: May 16, 2001

REMARKS: _____

ROLL CALL VOTE				
	AYES	NOES	ABS	EX
Arakaki	X			
Chung	X			
Elarionoff	X			
Jacobson		X		
Leithead-Todd			X	
Pisicchio	X			
Safarik	X			
Tyler	X			
Yagong	X			
	7	1	1	0

ROLL CALL VOTE				
	AYES	NOES	ABS	EX
Arakaki			X	
Chung	X			
Elarionoff	X			
Jacobson		X		
Leithead-Todd	X			
Pisicchio	X			
Safarik	X			
Tyler	X			
Yagong	X			
	7	1	1	0

I DO HEREBY CERTIFY that the foregoing BILL was adopted by the County Council published as indicated above.

APPROVED AS TO
FORM AND LEGALITY:

DEPUTY CORPORATION COUNSEL
COUNTY OF HAWAII

Date May 7, 2001



COUNCIL CHAIRMAN

COUNTY CLERK

Approved/Disapproved this 9th day
of May, 2001

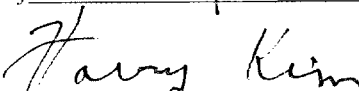
MAYOR, COUNTY OF HAWAII

Bill No.: 45
Reference: C-159/PC-19
Ord. No.: 01 46