



ORDINANCE NO. 02 2

AN ORDINANCE AMENDING THE STATE LAND USE BOUNDARIES MAP, H-14 FOR THE COUNTY OF HAWAII, BY CHANGING THE DISTRICT CLASSIFICATION FROM THE AGRICULTURAL TO THE RURAL DISTRICT AT OULI, WAIMEA, SOUTH KOHALA, HAWAII, COVERED BY TAX MAP KEY 6-2-11:15.

BE IT ORDAINED BY THE COUNCIL OF THE COUNTY OF HAWAII:

SECTION 1. The State Land Use Boundaries Map, H-14 for the County of Hawaii, is amended to change the district classification of property described hereinafter as follows:

The district classification of the following area situated at Ouli, Waimea, South Kohala, Hawaii, shall be Residential and Agricultural (RA-2a):

Beginning at the Northeasterly corner of this parcel of land, being also the Northwesterly corner of Lot 14 of this subdivision and being a point on the Southerly Side of Kanehoa Street, the coordinates of said point of beginning referred to Government Survey Triangulation Station "PUU PA" being 11,333.75 feet North and 14,072.05 feet West and running by azimuths measured clockwise from True South:

1. 357° 28' 30" 897.48 feet along Lot 14 of Anekona Estates and along the remainder of Royal Patent 2237, Land Commission Award 8518-B, Apana 1 to James Young Kanehoa to a point;
2. 88° 29' 10" 84.05 feet along middle of Keanuiomano Stream and along Government Land (State of Hawaii) to a point;
3. 100° 22' 30" 114.60 feet along middle of Keanuiomano Stream and along Government Land (State of Hawaii) to a point;
4. 166° 20' 815.56 feet along Lots 17 and 16 of Anekona Estates and along the remainder of Royal Patent 2237, Land

Commission Award 8518-B, Apana 1 to James Young Kanehoa to a point;

5. 253° 42' 157.03 feet along the Southerly side of Kanehoa Street to a point;

Thence, following along the Southerly side of Kanehoa Street on a curve to the right with a radius of 1,300.00 feet, the chord azimuth and distance being:

6. 258° 11' 20" 203.49 feet to the point of beginning and containing an area of 5.453 Acres.

All as shown on the map attached hereto, marked Exhibit "A" and by reference made a part hereof.

SECTION 2. In the event that any portion of this ordinance is declared invalid, such invalidity shall not affect the other parts of this ordinance.

SECTION 3. This ordinance shall take effect upon its approval.

INTRODUCED BY:

  
COUNCIL MEMBER, COUNTY OF HAWAII

Hilo, Hawaii

Date of Introduction: December 5, 2001  
Date of 1st Reading: December 5, 2001  
Date of 2nd Reading: December 19, 2001  
Effective Date: January 8, 2002

REFERENCE: Comma. 412

APPROVED AS TO FORM AND LEGALITY

\_\_\_\_\_  
CORPORATION COUNSEL

DATED: \_\_\_\_\_

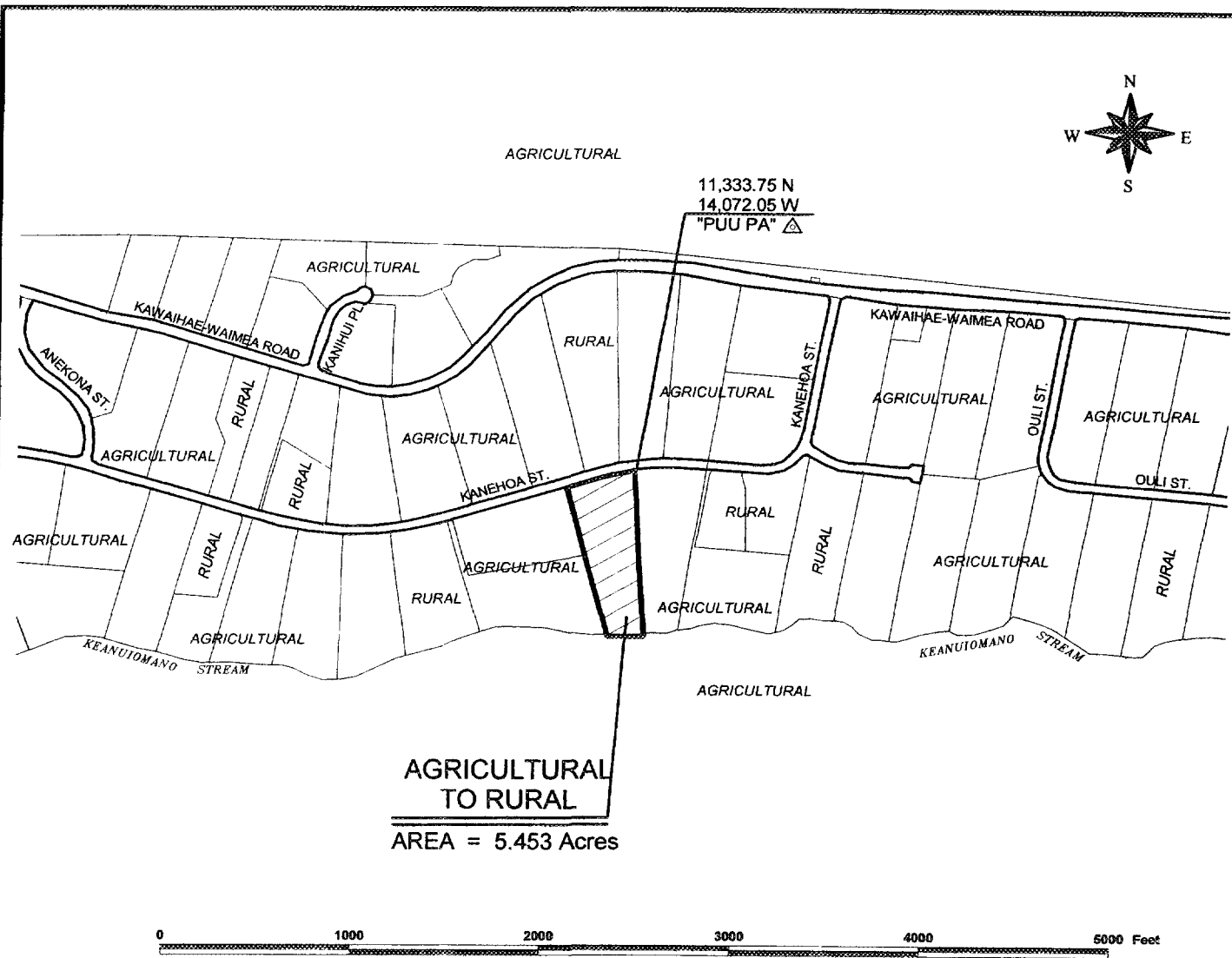
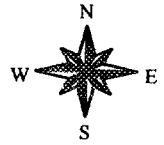

# AMENDMENT TO STATE LAND USE BOUNDARIES MAP

AMENDING THE STATE LAND USE BOUNDARIES MAP, H-14 FOR THE COUNTY OF HAWAII,  
BY CHANGING THE DISTRICT CLASSIFICATION FROM  
THE AGRICULTURAL TO THE RURAL DISTRICT  
AT OULI, SOUTH KOHALA, HAWAII.

PREPARED BY: PLANNING DEPARTMENT  
COUNTY OF HAWAII

TMK : 6-2-11:15

SEPT. 13, 2001

EXHIBIT "A"

(Clinton & Williams)

OFFICE OF THE COUNTY CLERK  
 County of Hawaii  
Hilo, Hawaii

Introduced By: Bobby Jean Leithead-Todd  
 Date Introduced: December 5, 2001  
 First Reading: December 5, 2001  
 Published: N/A

REMARKS: \_\_\_\_\_  
 \_\_\_\_\_  
 \_\_\_\_\_  
 \_\_\_\_\_

Second Reading: December 19, 2001  
 To Mayor: December 21, 2001  
 Returned: January 4, 2002  
 Effective: January 8, 2002  
 Published: January 22, 2002

REMARKS: Returned unsigned 1/4/02  
 \_\_\_\_\_  
 \_\_\_\_\_  
 \_\_\_\_\_

JUL 4 PM 8 11  
 COUNTY CLERK

ROLL CALL VOTE				
	AYES	NOES	ABS	EX
Arakaki	X			
Chung	X			
Elarionoff	X			
Jacobson		X		
Leithead-Todd	X			
Pisicchio	X			
Safarik	X			
Tyler	X			
Yagong	X			
	8	1	0	0

ROLL CALL VOTE				
	AYES	NOES	ABS	EX
Arakaki	X			
Chung	X			
Elarionoff	X			
Jacobson		X		
Leithead-Todd			X	
Pisicchio	X			
Safarik	X			
Tyler	X			
Yagong	X			
	7	1	1	0

I DO HEREBY CERTIFY that the foregoing BILL was adopted by the County Council published as indicated above.

APPROVED AS TO  
 FORM AND LEGALITY:

DEPUTY CORPORATION COUNSEL  
 COUNTY OF HAWAII

Date \_\_\_\_\_

Approved/Disapproved this \_\_\_\_\_ day  
 of \_\_\_\_\_, 20\_\_\_\_\_.

  
 COUNCIL CHAIRMAN

  
 COUNTY CLERK

Bill No.: 129  
 Reference: C-412/PC-44  
 Ord No.: 02 2

MAYOR, COUNTY OF HAWAII