

ORDINANCE NO. 04 47

AN ORDINANCE AMENDING THE STATE LAND USE BOUNDARIES MAP, H-15 FOR THE COUNTY OF HAWAI'I, BY CHANGING THE DISTRICT CLASSIFICATION FROM THE AGRICULTURAL TO THE URBAN DISTRICT AT WAIKOLOA, SOUTH KOHALA, HAWAI'I, COVERED BY TAX MAP KEY 6-8-2:PORTION OF 33.

BE IT ORDAINED BY THE COUNCIL OF THE COUNTY OF HAWAI'I:

SECTION 1. The State Land Use Boundaries Map, H-15 for the County of Hawai'i, is amended to change the district classification of property described hereinafter as follows:

The district classification of the following area situated at Waikoloa, South Kohala, Hawai'i, shall be Urban:

Beginning at the Southernmost corner of this parcel of land, said point of beginning bearing 149° 12' 21" 1,486.72 feet from the Southernmost corner of Lot 3-B, the coordinates of said point of beginning referred to Government Survey Triangulation Station "PUU HINAI" being 4,605.29 feet North and 6,247.22 feet West and running by azimuths measured clockwise from True South:

Thence, for the next four (4) courses following along the remainders of Lot 3-B of Waikoloa Development and Royal Patent 5671, Land Commission Award 8521-B, Apana 1 to G. D. Hueu:

- |    |              |          |  |
|----|--------------|----------|--|
| 1. | 136° 30' 30" | 1,390.00 | feet to a point;   |
| 2. | 226° 30' 30" | 467.00   | feet to a point;   |
| 3. | 316° 30' 30" | 1,390.00 | feet to a point;   |
| 4. | 46° 30' 30"  | 467.00   | feet to the point of beginning and containing an area of 14.902 Acres. |

All as shown on the map attached hereto, marked Exhibit "A" and by reference made a part hereof.

SECTION 2. In the event that any portion of this ordinance is declared invalid, such invalidity shall not affect the other parts of this ordinance.

SECTION 3. This ordinance shall take effect upon its approval.

INTRODUCED BY:

  
COUNCIL MEMBER, COUNTY OF HAWAII

Hilo, Hawai'i

Date of Introduction: April 7, 2004  
Date of 1st Reading: April 7, 2004  
Date of 2nd Reading: April 21, 2004  
Effective Date: April 27, 2004

REFERENCE: Coram 514

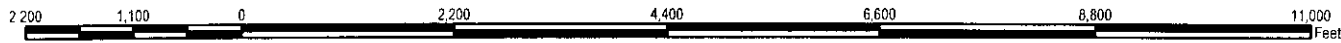
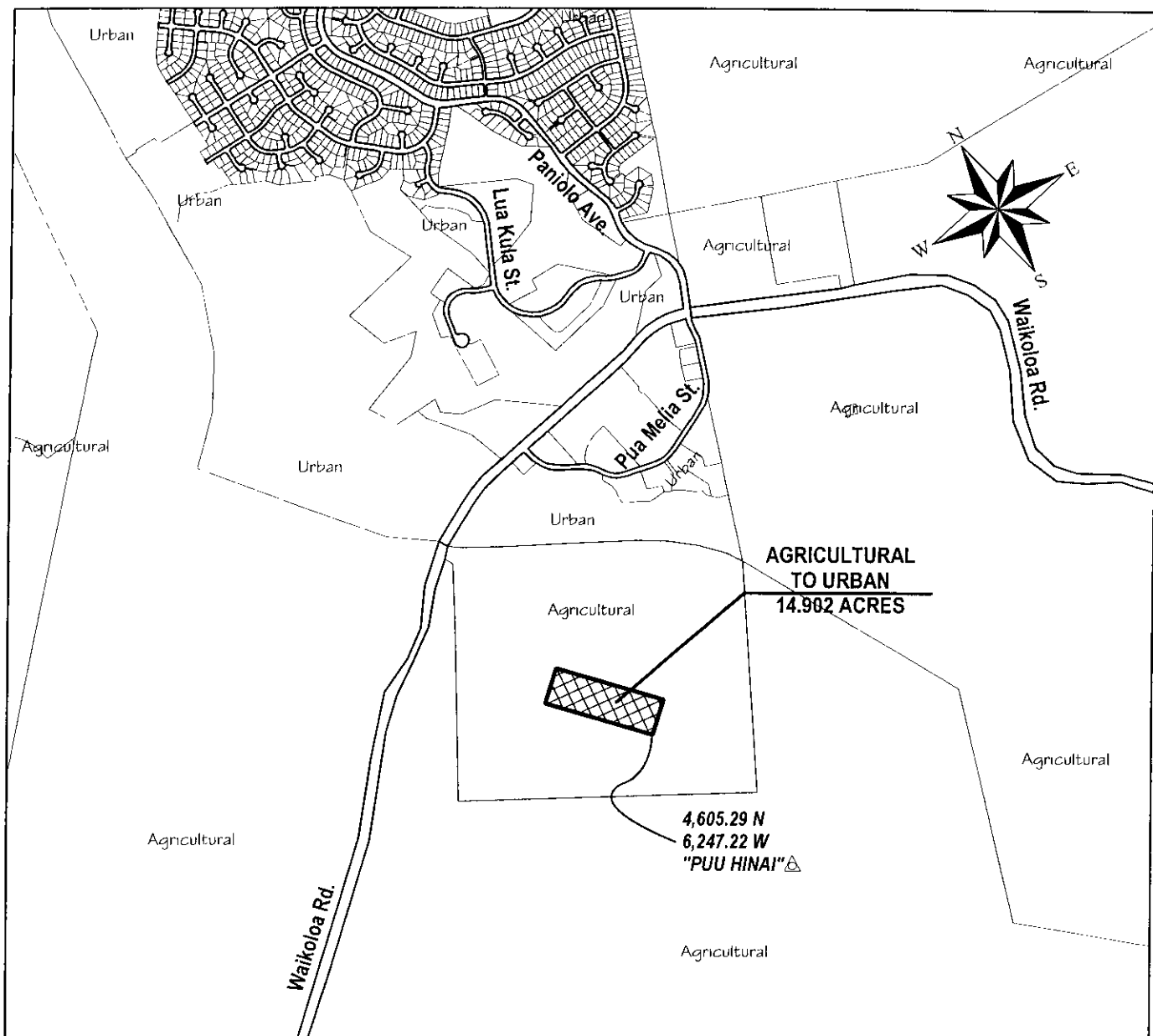

# AMENDMENT TO STATE LAND USE BOUNDARIES MAP

AMENDING THE STATE LAND USE BOUNDARIES MAP, H-7 FOR THE COUNTY OF HAWAII, BY CHANGING THE DISTRICT CLASSIFICATION FROM THE AGRICULTURAL TO THE URBAN DISTRICT AT WAIKOLOA, SOUTH KOHALA, HAWAII

PREPARED BY: PLANNING DEPARTMENT  
COUNTY OF HAWAII

OFFICE OF THE COUNTY CLERK  
 County of Hawaii  
 Hilo, Hawaii

2004 APR 27 PM 2:36

Introduced By: Leningrad Elarionoff  
 Date Introduced: April 7, 2004  
 First Reading: April 7, 2004  
 Published: N/A

REMARKS: \_\_\_\_\_  
 \_\_\_\_\_  
 \_\_\_\_\_  
 \_\_\_\_\_

Second Reading: April 21, 2004  
 To Mayor: April 22, 2004  
 Returned: April 27, 2004  
 Effective: April 27, 2004  
 Published: May 4, 2004

REMARKS: \_\_\_\_\_  
 \_\_\_\_\_  
 \_\_\_\_\_  
 \_\_\_\_\_

ROLL CALL VOTE				
	AYES	NOES	ABS	EX
Arakaki	X			
Chung	X			
Elarionoff			X	
Holschuh	X			
Jacobson	X			
Reynolds	X			
Safarik	X			
Tulang	X			
Tyler	X			
	8	0	1	0

ROLL CALL VOTE				
	AYES	NOES	ABS	EX
Arakaki	X			
Chung	X			
Elarionoff	X			
Holschuh	X			
Jacobson	X			
Reynolds	X			
Safarik	X			
Tulang	X			
Tyler	X			
	9	0	0	0

I DO HEREBY CERTIFY that the foregoing BILL was adopted by the County Council published as indicated above.

APPROVED AS TO  
 FORM AND LEGALITY:

Michael Lee  
 DEPUTY CORPORATION COUNSEL  
 COUNTY OF HAWAII

Date 4/26/04

[Signature]  
 COUNCIL CHAIRMAN  
[Signature]  
 COUNTY CLERK

Bill No.: 233  
 Reference: C-514/PC-80  
 Ord. No.: 04 47

Approved/Disapproved this 27<sup>th</sup> day  
 of April, 2004  
[Signature]  
 MAYOR, COUNTY OF HAWAII