

COUNTY OF HAWAI'I

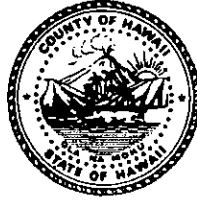

STATE OF HAWAI'I

ORDINANCE NO. 08 138 BILL NO. 362

AN ORDINANCE AMENDING THE STATE LAND USE BOUNDARIES MAPS FOR THE COUNTY OF HAWAI'I BY CHANGING THE DISTRICT CLASSIFICATION FROM THE AGRICULTURAL TO THE URBAN DISTRICT AT PUEHUEHU AND KAPUA, NORTH KOHALA, HAWAI'I, COVERED BY TAX MAP KEY: 5-4-008:PORTION 002.

BE IT ORDAINED BY THE COUNCIL OF THE COUNTY OF HAWAI'I:

SECTION 1. The State Land Use Boundaries Maps for the County of Hawai'i are amended to change the district classification of property described hereinafter as follows:

The district classification of the following area situated at Puehuehu and Kapua, North Kohala, Hawai'i, shall be Urban:

Beginning at the southwest corner of this parcel of land, the direct azimuth and distance from the southwest corner of Lot A being: 205° 03' 193.97 feet, the coordinates of said point of beginning referred to Government Survey Triangulation Station "PUU O NALE", being 12,990.72 feet North and 9,573.36 feet East, thence running by azimuths measured clockwise from true South:

- | | | | |
|----|----------|--------|--|
| 1. | 205° 03' | 418.38 | feet along the remainder of Grant 1544 to Makanoanoa, Maria and Kaneihaiiau (Lots A and B); |
| 2. | 108° 25' | 125.84 | feet along the remainders of Grant 1544 to Makanoanoa, Maria and Kaneihaiiau, Grant 1956 to Poepoe and R.P. 7653, L. C. Aw. 8741 to Kalua (Lot B); |
| 3. | 205° 03' | 251.68 | feet along the remainders of R.P. 7653, L.C. Aw. 8741 to Kalua and Grant 1544 to Makanoanoa, Maria and Kaneihaiiau (Lot B); |
| 4. | 288° 25' | 400.00 | feet along the remainder of Grant 1544 to Makanoanoa, Maria and Kaneihaiiau (Lot B); |

- | | | | |
|----|----------|--------|---|
| 5. | 25° 03' | 350.00 | feet along the remainder of Grant 1544 to Makanoanoa, Maria and Kaneihaiiau (Lot B); |
| 6. | 108° 25' | 197.91 | feet along the remainder of Grant 1544 to Makanoanoa, Maria and Kaneihaiiau (Lot B); |
| 7. | 25° 03' | 329.44 | feet along the remainder of Grant 1544 to Makanoanoa, Maria and Kaneihaiiau (Lot B); |
| 8. | 115° 29' | 75.74 | feet along the remainder of Grant 1544 to Makanoanoa, Maria and Kaneihaiiau (remainder of Lot A) to the point of beginning and containing an area of 3.475 Acres. |

All as shown on the map attached hereto, marked Exhibit "A" and by reference made a part hereof.

SECTION 2. In the event that any portion of this ordinance is declared invalid, such invalidity shall not affect the other parts of this ordinance.

SECTION 3. This ordinance shall take effect upon its approval.

INTRODUCED BY:

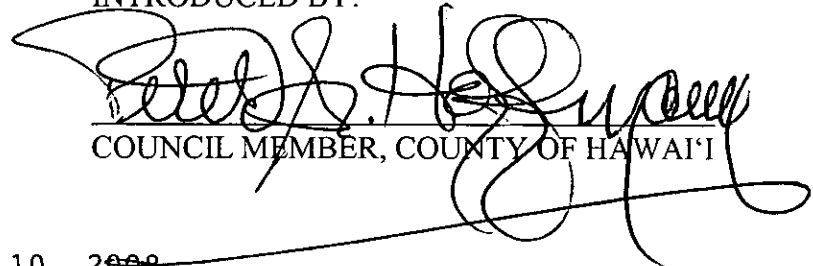

 COUNCIL MEMBER, COUNTY OF HAWAII

Hilo, Hawai'i

Date of Introduction: September 10, 2008
 Date of 1st Reading: September 10, 2008
 Date of 2nd Reading: September 24, 2008
 Effective Date: October 7, 2008

REFERENCE: Comm. 1401/waived/PC

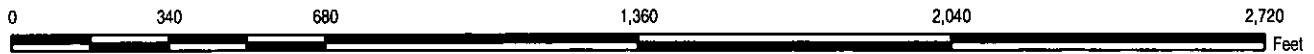
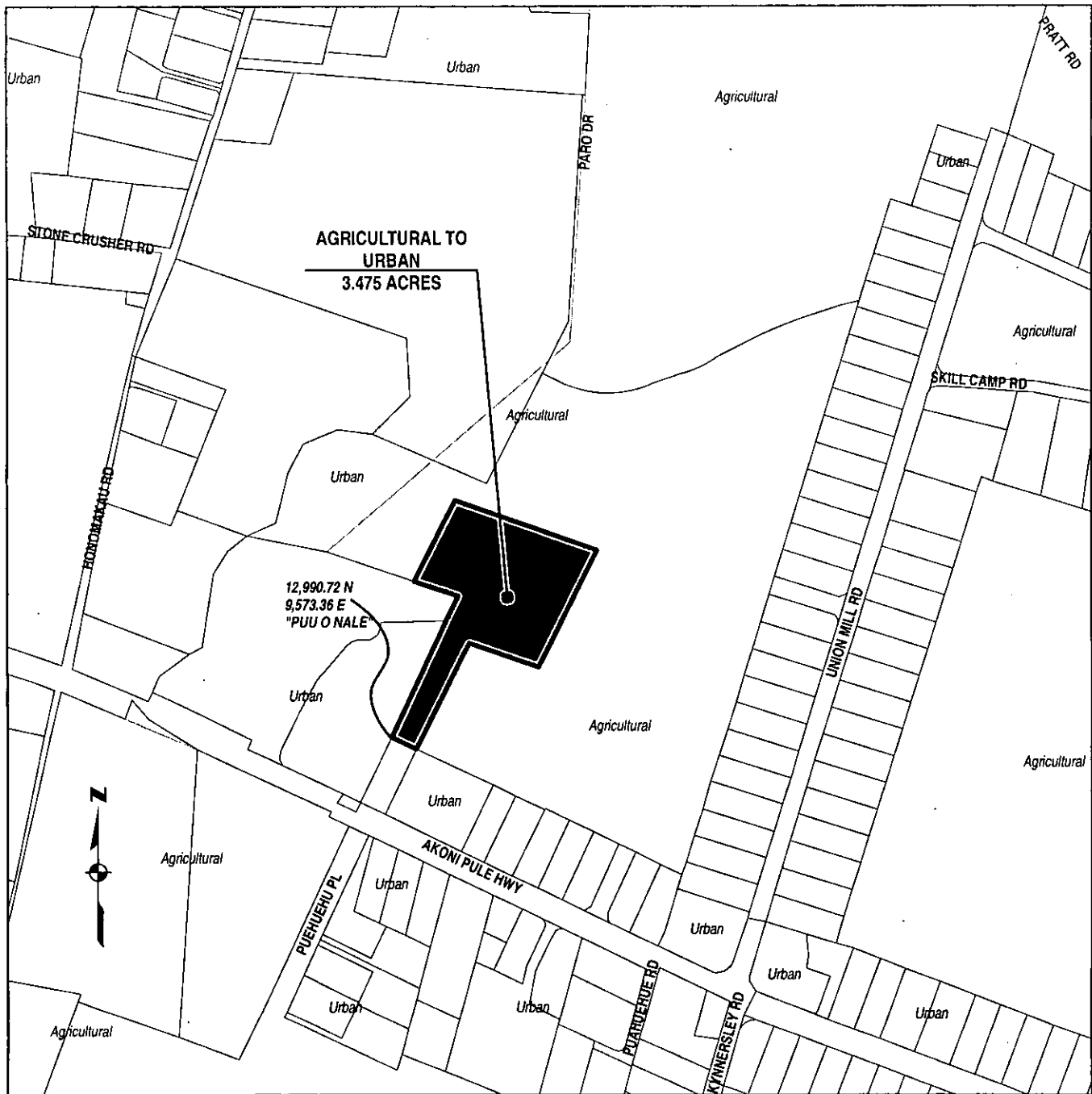

AMENDMENT TO STATE LAND USE BOUNDARIES MAPS

AMENDING THE STATE LAND USE BOUNDARIES MAPS FOR THE COUNTY OF HAWAII, BY CHANGING THE DISTRICT CLASSIFICATION FROM THE AGRICULTURAL DISTRICT TO THE URBAN DISTRICT AT PUEHUEHU AND KAPUA, NORTH KOHALA, HAWAII

MAP PREPARED BY:
COUNTY OF HAWAII, PLANNING DEPARTMENT

OFFICE OF THE COUNTY CLERK
 County of Hawai'i
 Hilo, Hawai'i

RECEIVED

Introduced By: Pete Hoffmann
 Date Introduced: September 10, 2008
 First Reading: September 10, 2008
 Published: N/A

REMARKS: _____

Second Reading: September 24, 2008
 To Mayor: October 2, 2008
 Returned: October 8, 2008
 Effective: October 7, 2008
 Published: October 15, 2008

REMARKS: _____

ROLL CALL VOTE				
	AYES	NOES	ABS	EX
Ford	X			
Higa	X			
Hoffmann	X			
Ikeda	X			
Jacobson	X			
Naeole	X			
Pilago	X			
Yagong	X			
Yoshimoto	X			
	9	0	0	0

ROLL CALL VOTE				
	AYES	NOES	ABS	EX
Ford	X			
Higa			X	
Hoffmann	X			
Ikeda	X			
Jacobson	X			
Naeole			X	
Pilago			X	
Yagong	X			
Yoshimoto	X			
	6	0	3	0

I DO HEREBY CERTIFY that the foregoing BILL was adopted by the County Council published as indicated above.

APPROVED AS TO
 FORM AND LEGALITY:

[Signature]
 DEPUTY CORPORATION COUNSEL
 COUNTY OF HAWAII

Date OCT - 3 2008

[Signature]
 COUNCIL CHAIRMAN
[Signature]
 COUNTY CLERK

Bill No.: 362
 Reference: C-1401/Waived-PC
 Ord No.: 08 138

Approved/Disapproved this 7th day
 of October, 2008
[Signature]

ACTING MAYOR, COUNTY OF HAWAII