

COUNTY OF HAWAI'I

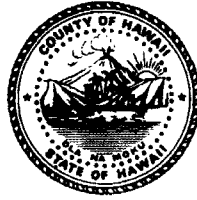

STATE OF HAWAI'I

ORDINANCE NO. 14 53 BILL NO. 211

AN ORDINANCE AMENDING THE STATE LAND USE BOUNDARIES MAPS FOR THE COUNTY OF HAWAI'I BY CHANGING THE DISTRICT CLASSIFICATION FROM THE AGRICULTURAL TO THE URBAN DISTRICT AT KEONEPOKO, PUNA, HAWAI'I (TAX MAP KEY: 1-5-007:061).

BE IT ORDAINED BY THE COUNCIL OF THE COUNTY OF HAWAI'I:

SECTION 1. The State Land Use Boundaries Maps for the County of Hawai'i are amended to change the district classification of property described hereinafter as follows:

The district classification of the following area situated at Keonepoko, Puna, Hawai'i, shall be Urban:

Beginning at the west corner of this lot, being also the north corner of Lot 8-C-2 of the subdivision of Lot 8-C and on the southeast side of Kahakai Road, the coordinates of said point of beginning referred to Government Survey Triangulation Station "PAHOA" being 756.35 feet north and 976.51 feet east, and thence running by azimuths measured clockwise from true South:

- |    |          |        |   |
|----|----------|--------|---|
| 1. | 250° 34' | 198.12 | feet along the southeast side of Kahakai road;  |
| 2. | 340° 34' | 219.87 | feet along Government Land;   |
| 3. | 70° 34'  | 198.12 | feet along Lot 8-B of the subdivision of Lot 8 of Keonepoko Homestead Lots;   |
| 4. | 160° 34' | 219.87 | feet along Lot 8-C-2 of the subdivision of Lot 8-C to the point of beginning and containing an area of 1.00 acre, more or less. |

All as shown on the map attached hereto, marked Exhibit "A" and by reference made a part hereof.

SECTION 2. This change in district classification is conditioned upon the following:

- A. The applicant shall notify prospective purchasers, tenants, or lessees of the subject property that farming operations and practices on adjacent or contiguous land in the State Land Use Agricultural District are protected under Hawai'i Revised Statutes Chapter 165, the Hawai'i Right to Farm Act. This notice shall be included in any disclosure required for the sale or transfer of the subject properties.
- B. Any action that would interfere with or restrain farming operations on adjacent or contiguous properties shall be prohibited; provided the farming operations are conducted in a manner consistent with generally accepted agricultural and management practices on adjacent or contiguous lands in the Agricultural District.

SECTION 3. In the event that any portion of this ordinance is declared invalid, such invalidity shall not affect the other parts of this ordinance.

SECTION 4. This ordinance shall take effect upon its approval.

INTRODUCED BY:

  
COUNCIL MEMBER, COUNTY OF HAWAI'I

Kona, Hawai'i

Date of Introduction: April 1, 2014  
Date of 1st Reading: April 1, 2014  
Date of 2nd Reading: April 16, 2014  
Effective Date: May 12, 2014

REFERENCE Comm. 716

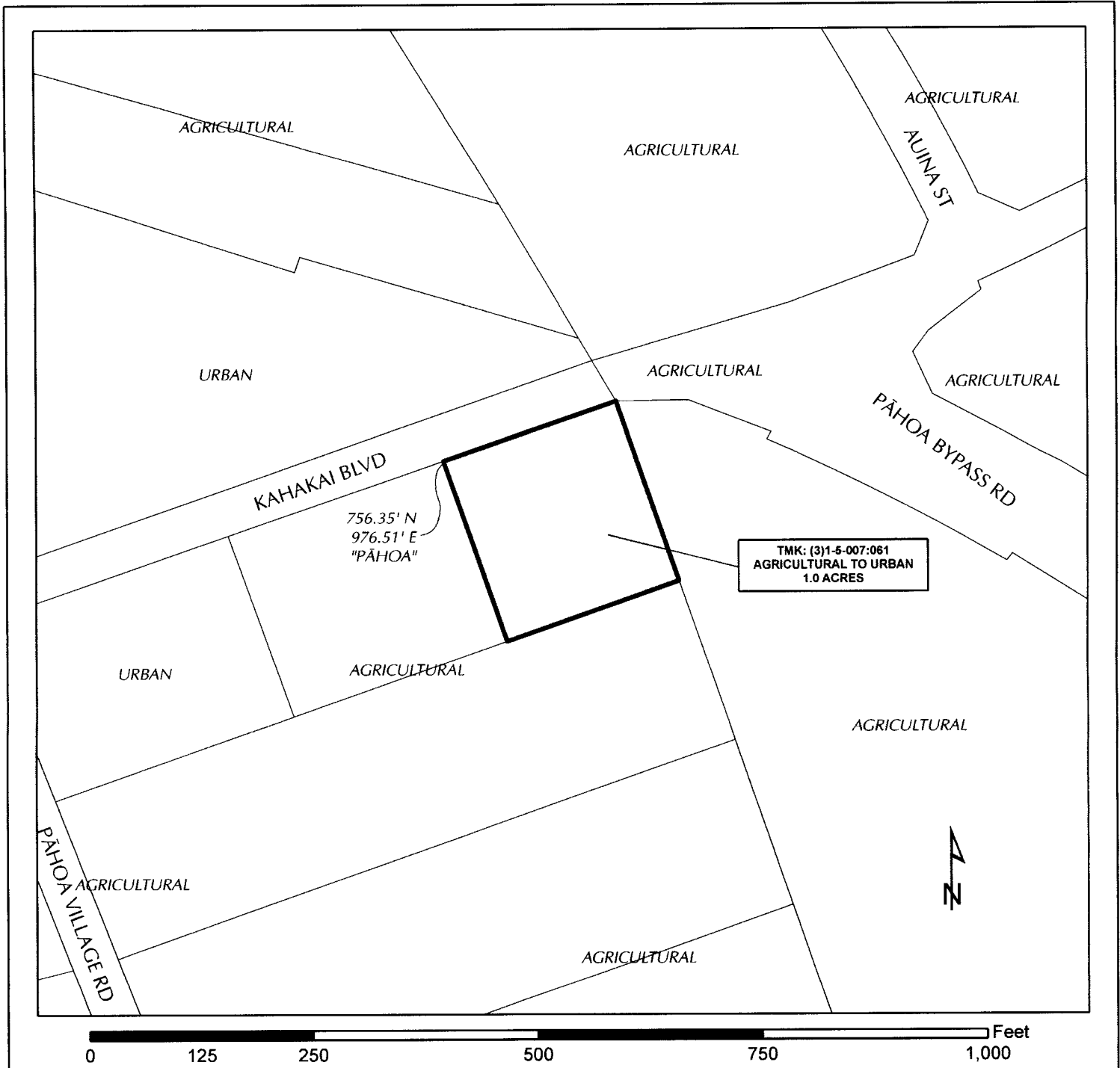

# AMENDMENT TO THE STATE LAND USE BOUNDARIES MAPS

AMENDING THE STATE LAND USE BOUNDARIES MAP  
 FOR THE COUNTY OF HAWAI'I, BY CHANGING THE DISTRICT CLASSIFICATION  
 FROM THE AGRICULTURAL DISTRICT TO THE URBAN DISTRICT  
 AT KEONEPOKO, PUNA, HAWAI'I

MAP PREPARED BY:  
 COUNTY OF HAWAI'I, PLANNING DEPARTMENT

TMK: (3) 1-5-007:061

DATE: Nov 6, 2013

**EXHIBIT "A"**

Jerry and Erlinda Souza  
 Map: 13-188

OFFICE OF THE COUNTY CLERK  
County of Hawai'i  
Kona, Hawai'i

COUNTY CLERK  
COUNTY OF HAWAII

2014 MAY 12 PM 3:32

Introduced By: Zendo Kern (B/R)  
Date Introduced: April 1, 2014  
First Reading: April 1, 2014  
Published: N/A

REMARKS: \_\_\_\_\_  
\_\_\_\_\_  
\_\_\_\_\_

Second Reading: April 16, 2014  
To Mayor: April 28, 2014  
Returned: May 12, 2014  
Effective: May 12, 2014  
Published: May 21, 2014

REMARKS: \_\_\_\_\_  
\_\_\_\_\_  
\_\_\_\_\_



ROLL CALL VOTE				
	AYES	NOES	ABS	EX
Eoff	X			
Ford	X			
Illagan	X			
Kanuha	X			
Kern	X			
Onishi	X			
Poindexter	X			
Wille	X			
Yoshimoto	X			
	9	0	0	0

ROLL CALL VOTE				
	AYES	NOES	ABS	EX
Eoff	X			
Ford	X			
Illagan	X			
Kanuha	X			
Kern	X			
Onishi	X			
Poindexter	X			
Wille	X			
Yoshimoto	X			
	9	0	0	0

I DO HEREBY CERTIFY that the foregoing BILL was adopted by the County Council published as indicated above.

Approved Disapproved this 12<sup>th</sup> day  
of May, 2014.

Wan K. Kern  
MAYOR, COUNTY OF HAWAII

  
COUNCIL CHAIRPERSON  
  
COUNTY CLERK

Bill No.: 211  
Reference: C-716/PC-58  
Ord No.: 11 53