

COUNTY OF HAWAI'I

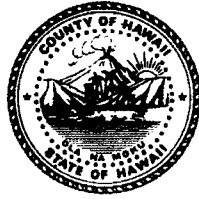

STATE OF HAWAI'I

ORDINANCE NO. 14 107 BILL NO. 267

AN ORDINANCE AMENDING THE STATE LAND USE BOUNDARIES MAPS FOR THE COUNTY OF HAWAI'I BY CHANGING THE DISTRICT CLASSIFICATION FROM THE AGRICULTURAL TO THE URBAN DISTRICT AT KAMĀ'OA, KA'Ū, HAWAI'I (TMK: 9-2-093:039, 040, 041 & 042).

BE IT ORDAINED BY THE COUNCIL OF THE COUNTY OF HAWAI'I:

SECTION 1. The State Land Use Boundaries Maps for the County of Hawai'i are amended to change the district classification of property described hereinafter as follows:

The district classification of the following area situated at Kamā'oa, Ka'ū, Hawai'i, shall be Urban:

Beginning at the Easternmost corner of this parcel of land, being also the Northernmost corner of Lot 10 of Block 157 of Hawaiian Ocean View Estates (File Plan 787) and being a point on the Southwesterly side of Lehua Lane, the coordinates of said point of beginning referred to Government Survey Triangulation Station "PUU O KAMA OA" being 1,976.65 feet North and 4,186.36 feet West and running by azimuths measured clockwise from True South:

- | | | | |
|----|--------------|--------|---|
| 1. | 19° 35' | 374.80 | feet along Lot 10 of Block 157 of Hawaiian Ocean View Estates (File Plan 787) and along the remainder of Grant 2791 to C. C. Harris to a point; |
| 2. | 109° 34' 52" | 325.00 | feet along the Northeasterly side of Hawai'i Belt Road to a point; |
| 3. | 199° 35' | 606.84 | feet along Lot 5 of Block 157 of Hawaiian Ocean View Estates (File Plan 787) feet to a point; |

4. 251° 01' 30" 89.52 feet along the Southeasterly side of Keaka Parkway to a point;
Thence, following along the Southwesterly intersection of Keaka Parkway and Lehua Lane on a curve to the right with a radius of 20.00 feet, the chord azimuth and distance being:
5. 296° 01' 30" 28.28 feet to a point;
6. 341° 01' 30" 364.02 feet along the Southwesterly side of Lehua Lane to the point of beginning and containing an area of 4.143 Acres.

All as shown on the map attached hereto, marked Exhibit "A" and by reference made a part hereof.

SECTION 2. In the event that any portion of this ordinance is declared invalid, such invalidity shall not affect the other parts of this ordinance.

SECTION 3. This ordinance shall take effect upon its approval.

INTRODUCED BY:

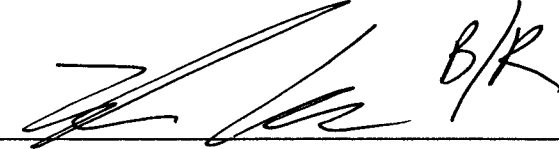

 COUNCIL MEMBER, COUNTY OF HAWAI'I

Kona, Hawai'i

Date of Introduction: August 6, 2014
 Date of 1st Reading: August 6, 2014
 Date of 2nd Reading: August 20, 2014
 Effective Date: September 12, 2014

REFERENCE Comm. 939

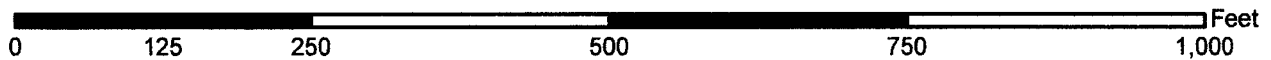
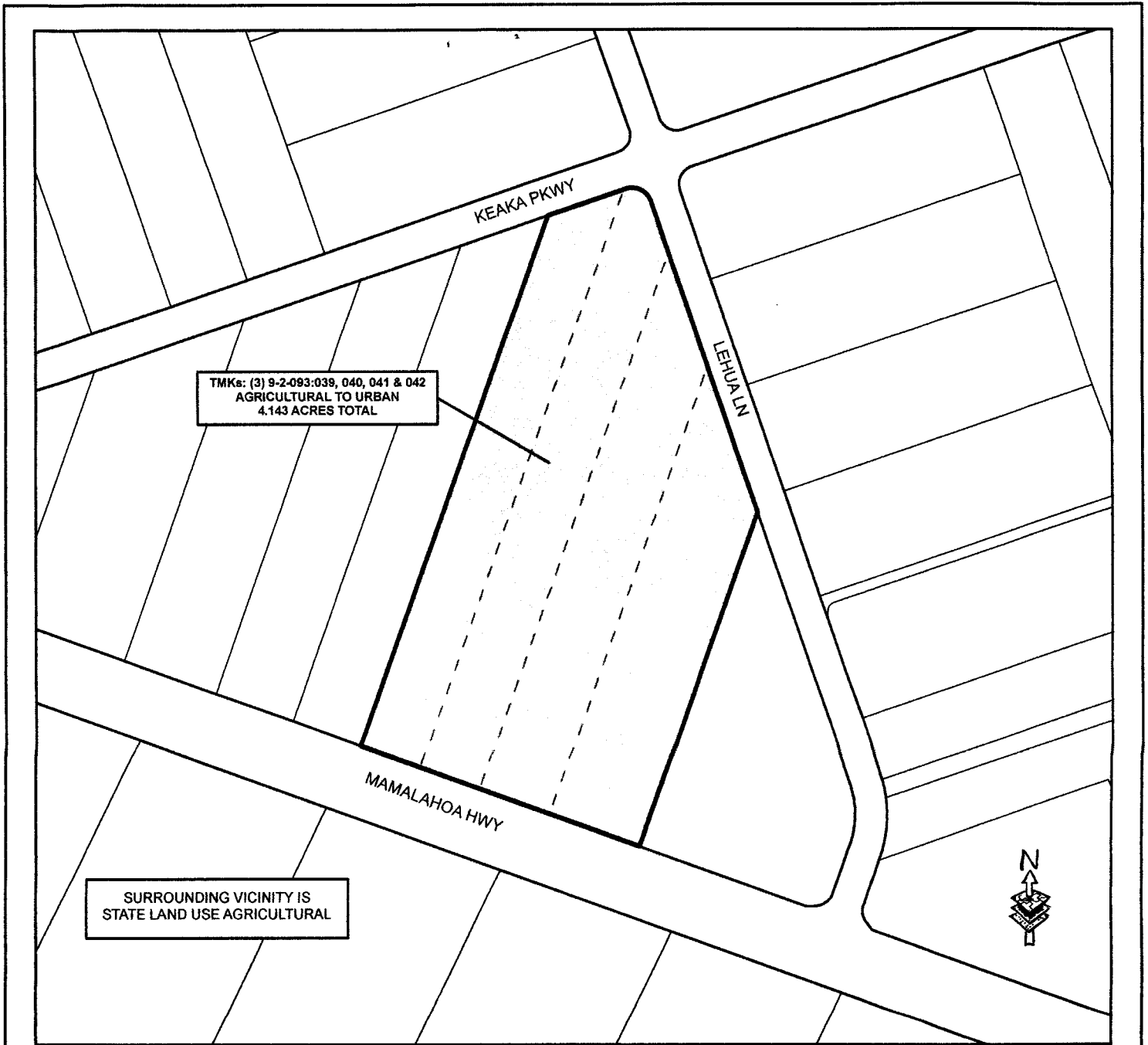

AMENDMENT TO THE STATE LAND USE BOUNDARIES MAPS

AMENDING THE STATE LAND USE BOUNDARIES MAP
 FOR THE COUNTY OF HAWAII, BY CHANGING THE DISTRICT CLASSIFICATION
 FROM THE AGRICULTURAL DISTRICT TO THE URBAN DISTRICT
 AT KAMA'OA, KA'U, HAWAII

MAP PREPARED BY:
 COUNTY OF HAWAII, PLANNING DEPARTMENT

TMK: (3) 9-2-093:039, 040, 041 & 042

DATE: May 28, 2014

EXHIBIT "A"

Dr William C. Foulk
 Map: 12-186

OFFICE OF THE COUNTY CLERK
 County of Hawai'i
 Kona, Hawai'i

COUNTY CLERK
 COUNTY OF HAWAII

2014 SEP 12 PM 2: 49

Introduced By: Zendo Kern (B/R)
 Date Introduced: August 6, 2014
 First Reading: August 6, 2014
 Published: N/A

REMARKS: _____

Second Reading: August 20, 2014
 To Mayor: August 28, 2014
 Returned: September 12, 2014
 Effective: September 12, 2014
 Published: September 20, 2014

REMARKS: _____

ROLL CALL VOTE				
	AYES	NOES	ABS	EX
Eoff	X			
Ford	X			
Ilagan	X			
Kanuha	X			
Kern	X			
Onishi	X			
Poindexter	X			
Wille	X			
Yoshimoto	X			
	9	0	0	0

ROLL CALL VOTE				
	AYES	NOES	ABS	EX
Eoff	X			
Ford	X			
Ilagan	X			
Kanuha	X			
Kern	X			
Onishi			X	
Poindexter	X			
Wille	X			
Yoshimoto	X			
	8	0	1	0

I DO HEREBY CERTIFY that the foregoing BILL was adopted by the County Council published as indicated above.

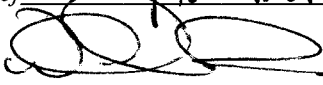
Approved/Disapproved this 12th day
 of September, 2014.

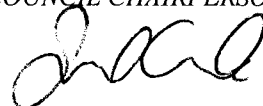
 MAYOR, COUNTY OF HAWAII

 COUNCIL CHAIRPERSON

 COUNTY CLERK

Bill No.: 267
 Reference: C-939/PC-73
 Ord No.: 14 107