

COUNTY OF HAWAI'I

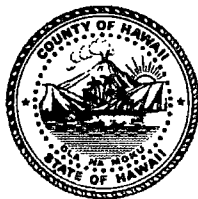

STATE OF HAWAI'I

ORDINANCE NO. 169 BILL NO. 127

AN ORDINANCE AMENDING THE STATE LAND USE BOUNDARIES MAPS FOR THE COUNTY OF HAWAI'I, BY CHANGING THE DISTRICT CLASSIFICATION FROM THE AGRICULTURAL DISTRICT TO THE URBAN DISTRICT AT PANA'EWA HOUSE LOTS, 2ND SERIES, SOUTH HILO, HAWAI'I, COVERED BY TAX MAP KEY: 2-2-056:002.

BE IT ORDAINED BY THE COUNCIL OF THE COUNTY OF HAWAI'I:

SECTION 1. The State Land Use Boundaries Maps for the County of Hawai'i are amended to change the district classification of property described hereinafter as follows:

The district classification of the following area situated at Pana'ewa House Lots 2<sup>nd</sup> Series, South Hilo, Hawai'i, shall be Urban:

Beginning at the west corner of this lot, the north corner of Lot 11 of Pana'ewa House Lots, 2<sup>nd</sup> Series, and on the southeast side of Mamaki Street, the coordinates of said point of beginning referred to Government Survey Triangulation Station "HĀLA'I" being 19,013.45 feet South and 14,575.44 feet East, as shown on Government Survey Registered Map HSS Plat 922-A, thence running by azimuths measured clockwise from True South:

1. 237° 41' 30" 245.66 feet along the southeast side of Mamaki Street;
2. Thence along the westerly side of Awa Street on a curve to the right having a radius of 50.00 feet, the chord azimuth and distance being 289° 20' 45" 78.43 feet;
3. 341° 00' 409.49 feet along the westerly side of Awa Street;

4. 57° 41' 30" 200.06 feet along Government Land;
5. 147° 41' 30" 460.00 feet along Lot 11 of Pana'ewa House Lots, 2<sup>nd</sup> Series, to the point of beginning and containing an area of 2.666 acres.

All as shown on the map attached hereto, marked Exhibit "A" and by reference made a part hereof.

SECTION 2. In the event that any portion of this ordinance is declared invalid, such invalidity shall not affect the other parts of this ordinance.

SECTION 3. This ordinance shall take effect upon its approval.

INTRODUCED BY:

  
COUNCIL MEMBER, COUNTY OF HAWAII

Hilo, Hawai'i

Date of Introduction: January 22, 2016  
Date of 1st Reading: January 22, 2016  
Date of 2nd Reading: February 3, 2016  
Effective Date: February 22, 2016

REFERENCE Comm. 612

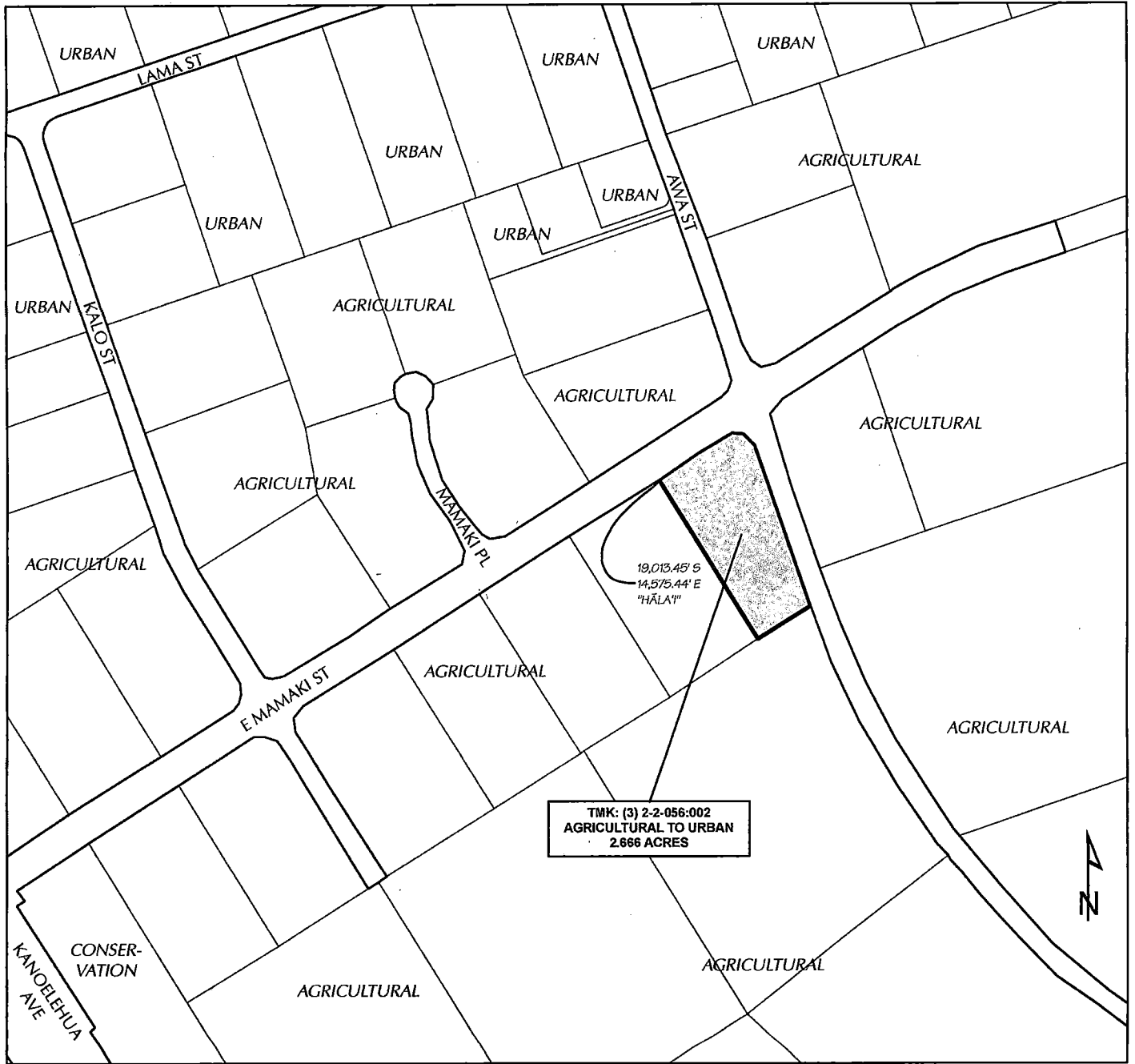

TMK: (3) 2-2-056:002  
 AGRICULTURAL TO URBAN  
 2.666 ACRES

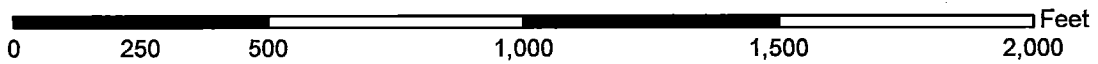

# **AMENDMENT TO THE STATE LAND USE BOUNDARIES MAPS**

AMENDING THE STATE LAND USE BOUNDARIES MAP FOR THE COUNTY OF HAWAII, BY CHANGING THE DISTRICT CLASSIFICATION FROM THE AGRICULTURAL DISTRICT TO THE URBAN DISTRICT AT PANA'EWA HOUSELOTS, 2ND SERIES, SOUTH HILO, HAWAII

MAP PREPARED BY:  
 COUNTY OF HAWAII, PLANNING DEPARTMENT

TMK: (3) 2-2-056:002

DATE: Aug 3, 2015

EXHIBIT "A"

Takehiro  
 Map 15-191

OFFICE OF THE COUNTY CLERK  
 County of Hawai'i  
 Hilo, Hawai'i

COUNTY CLERK  
 COUNTY OF HAWAII

2016 FEB 23 PM 2:31

Introduced By: Greggor Ilagan (B/R)  
 Date Introduced: January 22, 2016  
 First Reading: January 22, 2016  
 Published: January 30, 2016

REMARKS: \_\_\_\_\_  
 \_\_\_\_\_  
 \_\_\_\_\_  
 \_\_\_\_\_

Second Reading: February 3, 2016  
 To Mayor: February 11, 2016  
 Returned: February 23, 2016  
 Effective: February 22, 2016  
 Published: March 5, 2016



REMARKS: \_\_\_\_\_  
 \_\_\_\_\_  
 \_\_\_\_\_  
 \_\_\_\_\_

ROLL CALL VOTE				
	AYES	NOES	ABS	EX
Chung			X	
David	X			
Eoff	X			
Ilagan	X			
Kanuha	X			
Onishi	X			
Paleka	X			
Poindexter	X			
Wille	X			
	8	0	1	0

ROLL CALL VOTE				
	AYES	NOES	ABS	EX
Chung	X			
David	X			
Eoff	X			
Ilagan	X			
Kanuha	X			
Onishi	X			
Paleka	X			
Poindexter	X			
Wille	X			
	9	0	0	0

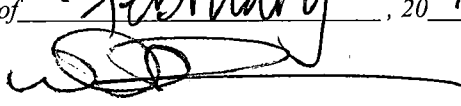
I DO HEREBY CERTIFY that the foregoing BILL was adopted by the County Council published as indicated above.

Approved/Disapproved this 22<sup>nd</sup> day  
 of February, 2016  
  
 MAYOR, COUNTY OF HAWAII

  
 COUNCIL CHAIRPERSON  
  
 COUNTY CLERK

Bill No.: 127  
 Reference: C-612/PC-41  
 Ord No.: 169