

2007



NA ALA HELE
Hawaii Trail & Access System

April 2, 2007

MEMORANDIUM

TO: Jonathan Holmes. Staff Planner

THRU: Irving Kawashima. Na Ala Hele Trails & Access Specialist *IK*

FROM: Clement Chang Jr, Na Ala Hele Technician *CC*

RE: Ki'ilae Farms Subdivision

It has come to our attention that the proposed Ki'ilae Farms Subdivision by Ki'ilae Estates, LLC is in its final stages regarding permits from the County. The Na Ala Hele Trails & Access Program is interested in this project due to two trails that are documented by maps or oral testimony. The trails include the Ki'ilae-Keannapaakai Trail, site #23146, and the Kauleoli Trail.

A request to our Abstractor on Oahu regarding ownership of the two mentioned trails has been given high priority and we are requesting being in the loop on any decisions made by the County of Hawaii affecting the two said trails.

We will notify you of our results and are asking if further decisions regarding the project be put on hold until ownership is resolved.

EXHIBIT

B

026917

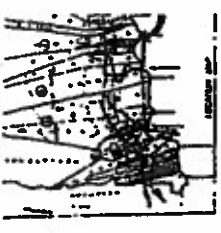

**PRELIMINARY
SUBDIVISION MAP
KILAUE PARKS**

CONVEYANCE OF LOTS 2, 3 & 4 OF SAID SUBDIVISION
Pursuant to the provisions of the
Act, Chapter 208, Sections 208-1 to 208-10,
Hawaii Revised Statutes, and the
Act, Chapter 208, Section 208-11, Hawaii
Revised Statutes, and the provisions of the
Act, Chapter 208, Section 208-12, Hawaii
Revised Statutes, the Board of Land and
Natural Resources has approved the
subdivision of the land shown on this map
into the lots shown on this map, subject to
the conditions set forth in the report of the
Board of Land and Natural Resources.

THE BOARD OF LAND AND NATURAL RESOURCES
HAS APPROVED THE SUBDIVISION OF THE
LAND SHOWN ON THIS MAP INTO THE LOTS
SHOWN ON THIS MAP, SUBJECT TO THE
CONDITIONS SET FORTH IN THE REPORT OF
THE BOARD OF LAND AND NATURAL RESOURCES.

RECORDED
AT THE OFFICE OF THE
DEPARTMENT OF LAND AND NATURAL RESOURCES
ON THIS 15TH DAY OF MARCH 1964
AT HONOLULU, HAWAII

*Kaulaoli - Kilaue
Boundary Wall*

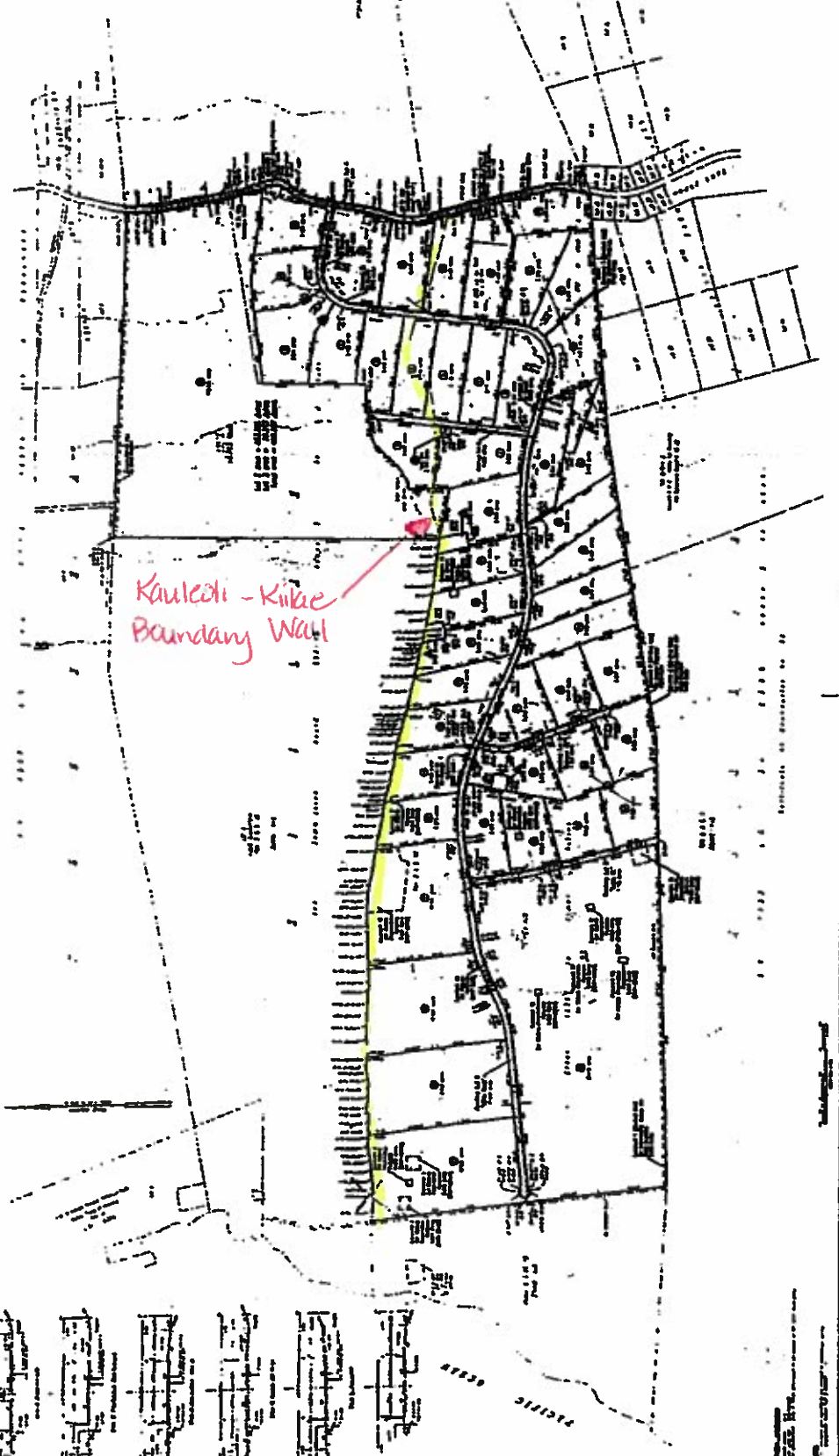

EXHIBIT

C

5

Figure 21a -
Departments of the Agriculture
Land in 1870s
An annotated Primary Area of the
of the Land Department
Copyright Department
of the Department of the
of the Department of the
of the Department of the

Scale 1 inch = 10 miles

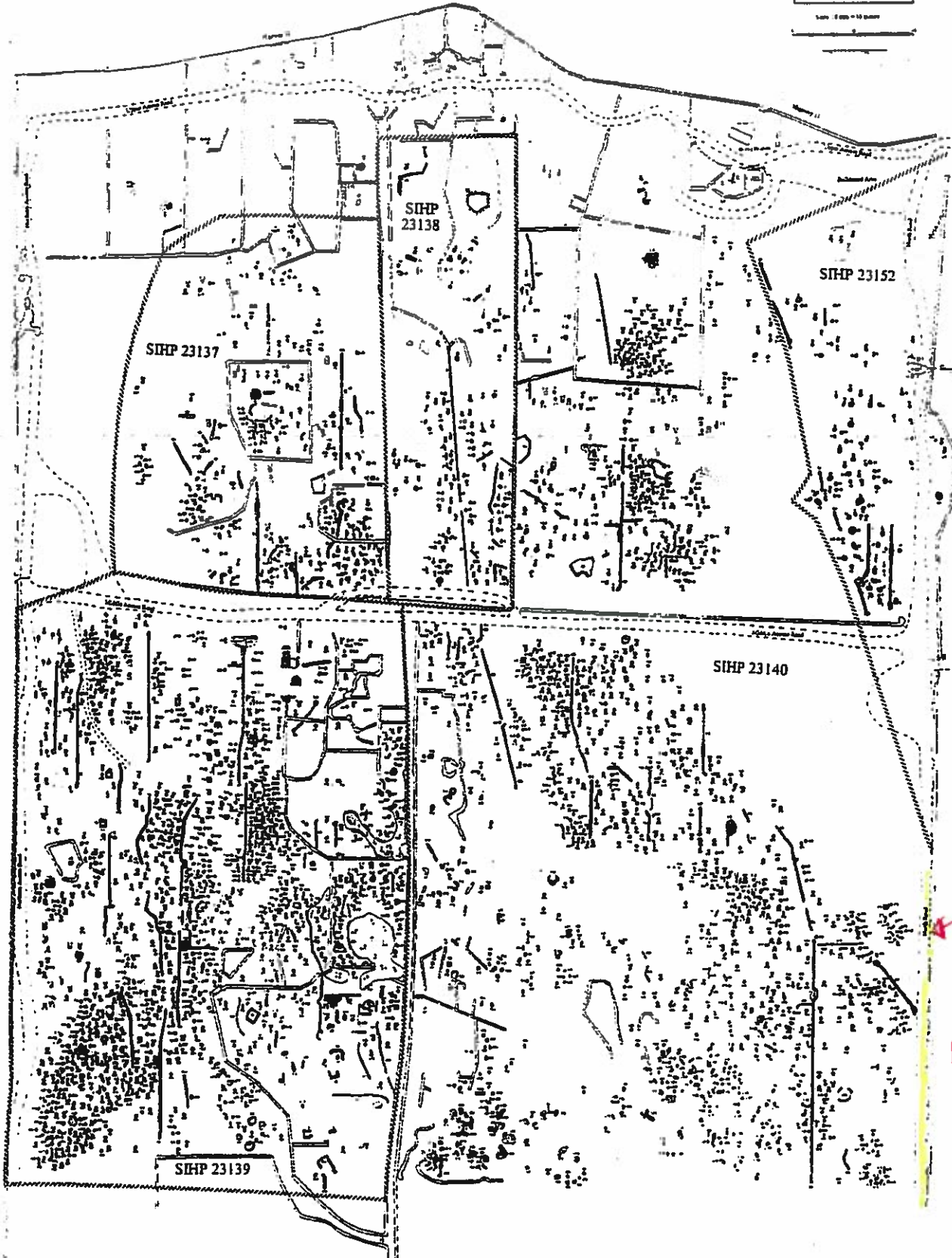

Kaulea Trail
along the
Kaulea-Kiilae
boundary wall

Figure 32a -
 Distribution of the Principal
 Sites at K'aua
 Archaeological Survey of the
 K'aua Island, Hawaii
 Scale: 1:50,000
 1960

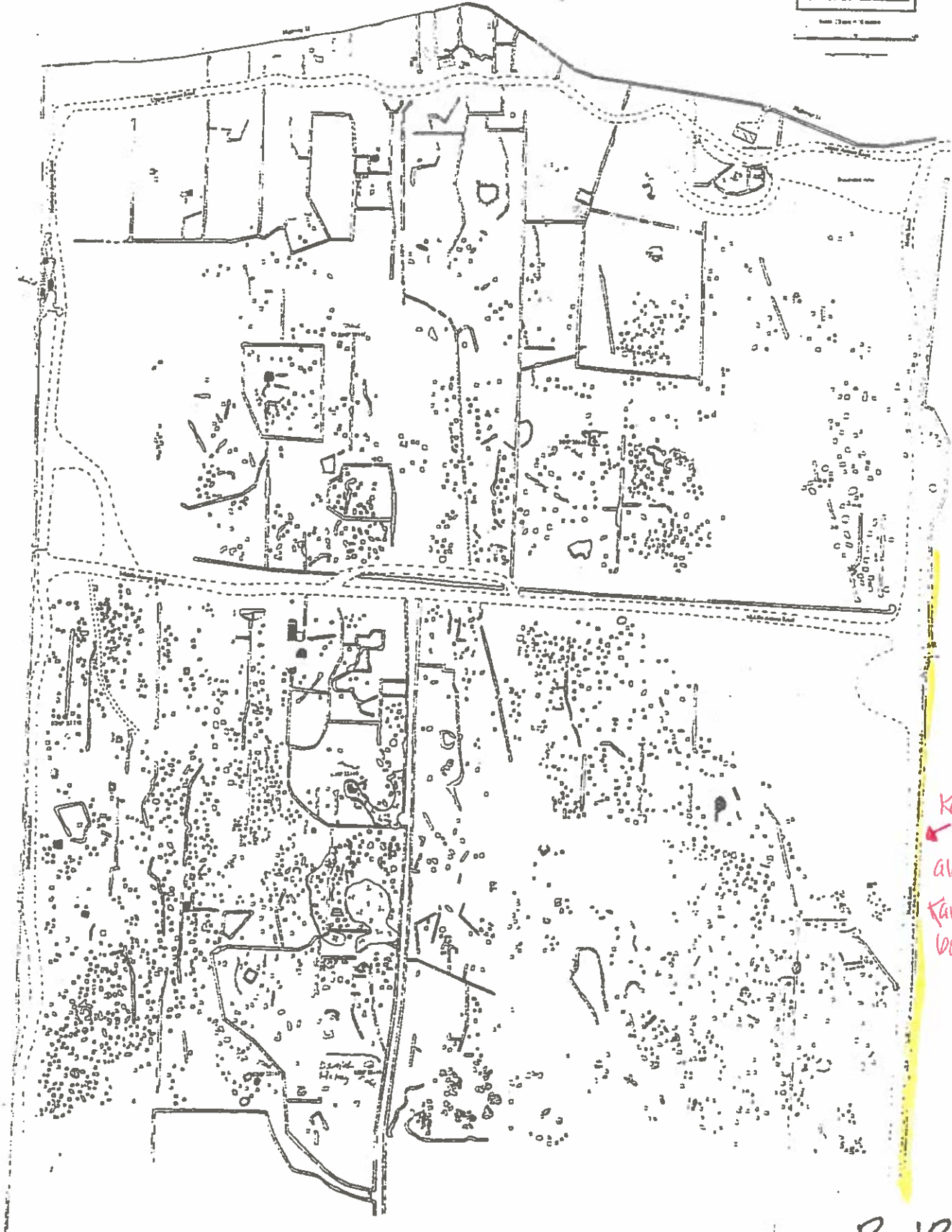

Kaukoli
 Trail
 along the
 Kaukoli-Kiika
 boundary

Koa Foot
Cave by Hamakua

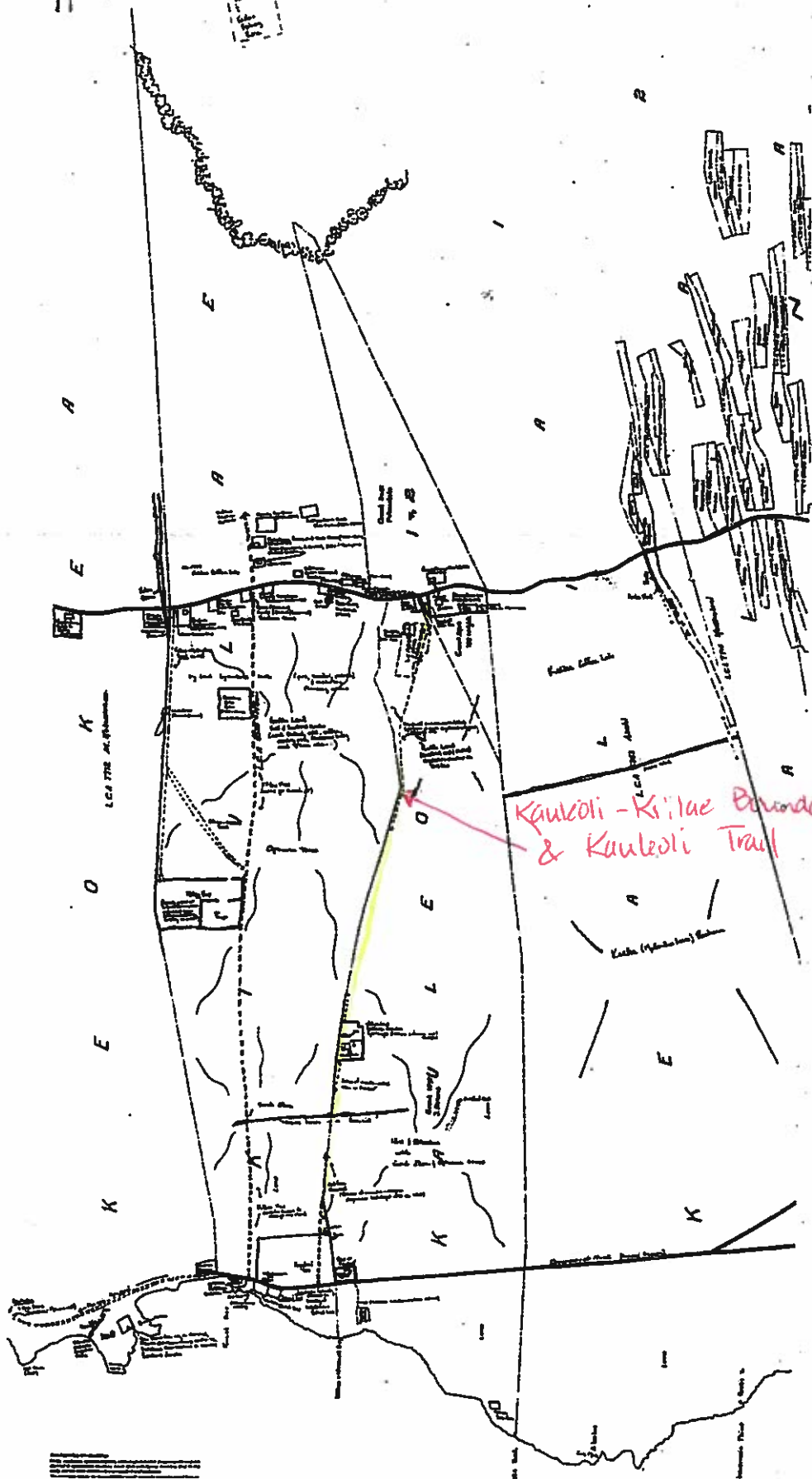

Kaukoi-Ki'iae Boundary Wall
& Kaukoi Trail

Scale
1" = 100'