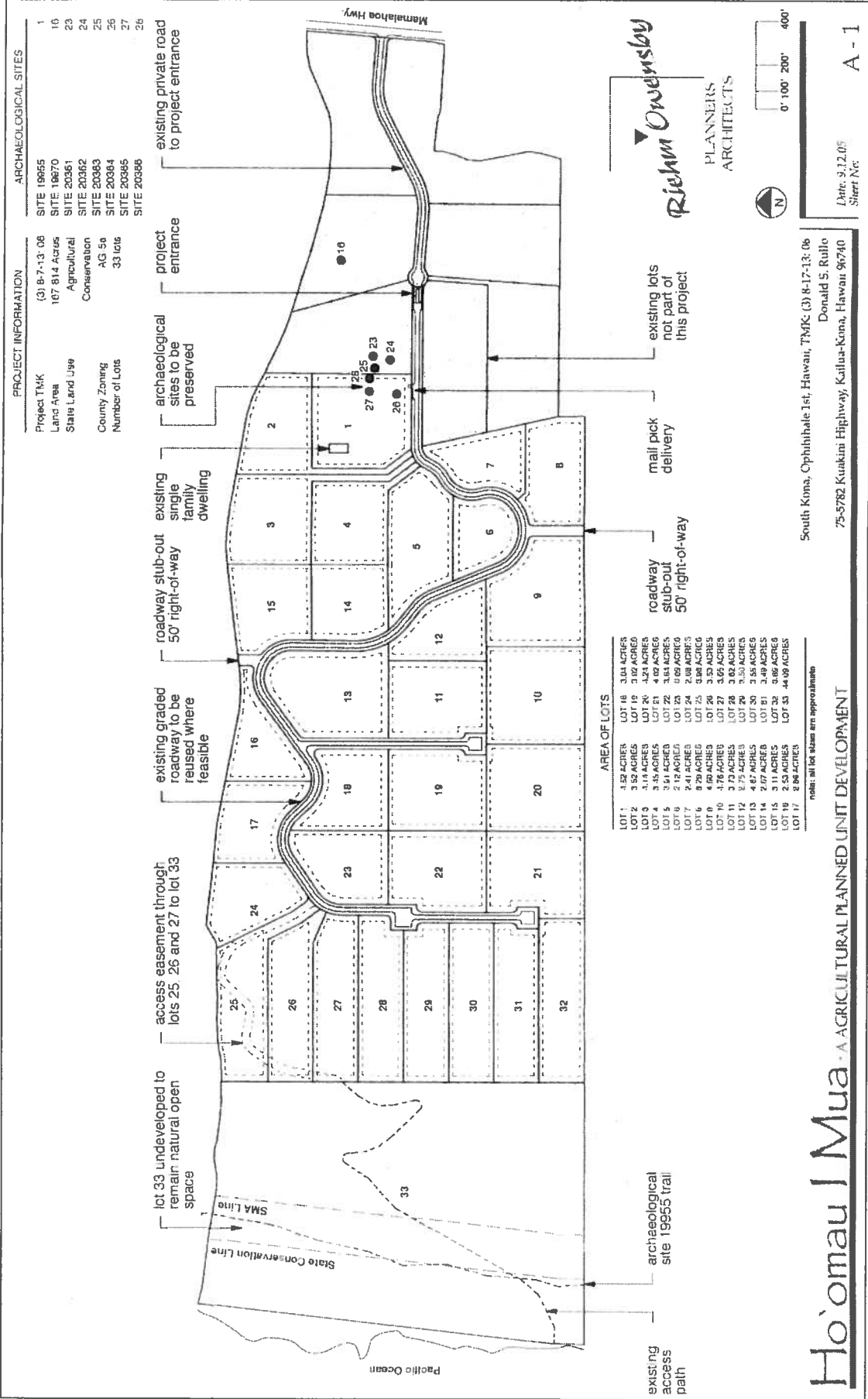

Exhibit A: Master Plan



PROJECT INFORMATION		ARCHAEOLOGICAL SITES	
Project TMAK	(3) B-7-13-06	SITE 19965	1
Land Area	107.814 Acres	SITE 19970	10
State Land Use	Agricultural Conservation	SITE 20361	23
		SITE 20362	24
County Zoning	AG 50	SITE 20363	25
Number of Lots	33 lots	SITE 20364	26
		SITE 20365	27
		SITE 20368	26

AREA OF LOTS	
LOT 1	1.52 ACRES
LOT 2	3.14 ACRES
LOT 3	3.14 ACRES
LOT 4	3.45 ACRES
LOT 5	3.54 ACRES
LOT 6	2.12 ACRES
LOT 7	2.41 ACRES
LOT 8	2.29 ACRES
LOT 9	1.76 ACRES
LOT 10	1.76 ACRES
LOT 11	2.73 ACRES
LOT 12	2.75 ACRES
LOT 13	4.67 ACRES
LOT 14	2.07 ACRES
LOT 15	3.11 ACRES
LOT 16	2.53 ACRES
LOT 17	2.86 ACRES
LOT 18	3.14 ACRES
LOT 19	3.14 ACRES
LOT 20	3.24 ACRES
LOT 21	4.02 ACRES
LOT 22	3.84 ACRES
LOT 23	0.09 ACRES
LOT 24	2.88 ACRES
LOT 25	3.88 ACRES
LOT 26	3.53 ACRES
LOT 27	3.53 ACRES
LOT 28	3.02 ACRES
LOT 29	3.53 ACRES
LOT 30	3.55 ACRES
LOT 31	3.49 ACRES
LOT 32	3.86 ACRES
LOT 33	44.09 ACRES
LOT 34	2.86 ACRES

note: all lot sizes are approximate

Riehm Owensby
 PLANNERS
 ARCHITECTS

South Kona, Ophihaleke 1st, Hawaii, TMAK (3) B-7-13-06
 Donald S. Rullo
 75-5782 Kuakini Highway, Kailua-Kona, Hawaii 96740
 Date: 9.12.05
 Sheet No: A-1

