

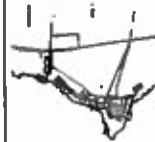

Traylor Associates, Inc.
 CIVIL ENGINEERS & LAND SURVEYORS
 1010 WASHINGTON STREET
 WILKES BARRE, PA 18703



ALL DIMENSIONS TO CENTERLINE UNLESS SPECIFICALLY NOTED
 ALL DIMENSIONS TO CENTERLINE UNLESS SPECIFICALLY NOTED
 ALL DIMENSIONS TO CENTERLINE UNLESS SPECIFICALLY NOTED



REVISION & DATE DESCRIPTION
EXISTING
JEEP ROAD REPAIR
 PESH 101 & 201 & 301 & 401
 TAC, 100 DRY 1/3/01 01
 SHEET TITLE
PLAN & PROFILE
ACCESS ROAD
 STA. 0+00 TO STA. 4+00
 DRAWING NUMBER
C2.1
 SHEET 3 OF 3

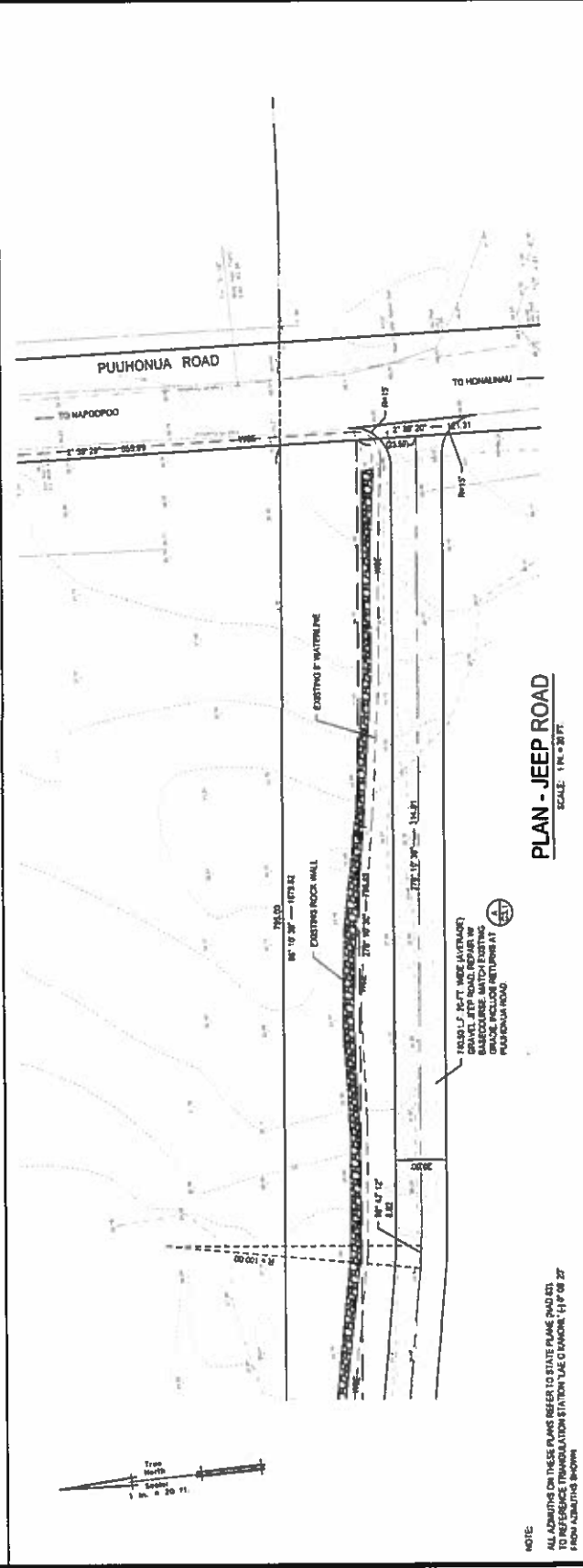
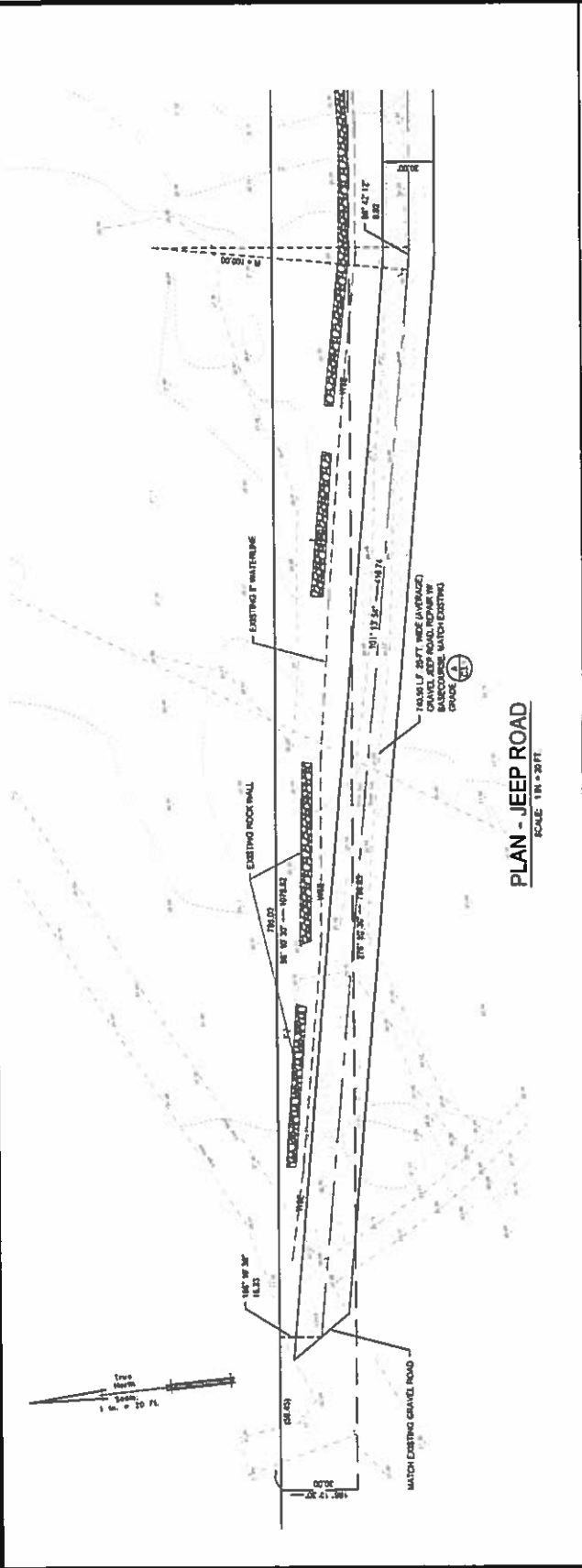

NOTE:
 ALL DIMENSIONS ON THESE PLANS REFER TO STATE PLANS 240 AND 241
 TO BE PLACED TRANSMISSION STATION CLAS O HAWAII 1/18/08 27
 FROM A241/18 BROWN

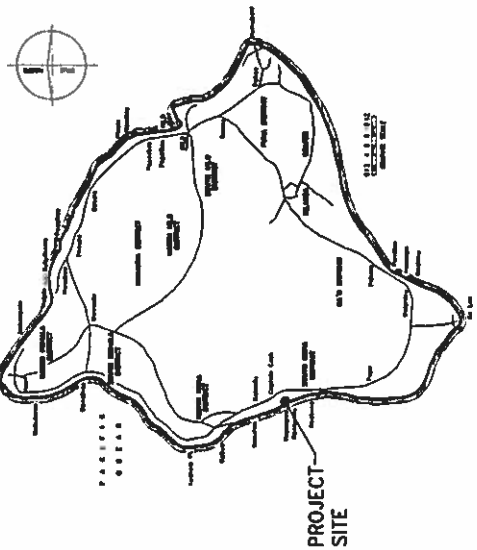

EXISTING JEEP ROAD REPAIRS

KE'EI 1ST & 2ND, SOUTH KONA, ISLAND OF HAWAII, HAWAII

TAX MAP KEY: 3RID DIV. 8 - 3 - 04: 01

prepared by: **IMATA & ASSOCIATES INC.**
 civil engineers • land surveyors
 171 kapiolani street
 hilo, hawaii 96720

owner:
KAMEHAMEHA SCHOOLS
LAND DIVISION
78-6831 ALII DRIVE
KAILUA-KONA, HAWAII 96740

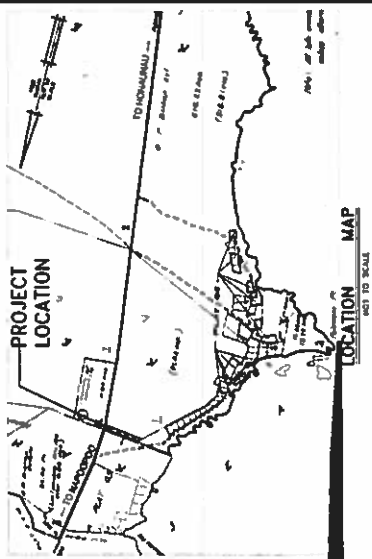

DEPARTMENT OF LAND AND NATURAL RESOURCES
 OFFICE OF CONSERVATION AND COASTAL LANDS
 STATE OF HAWAII

APPROVED

DATE



IMATA & ASSOCIATES, INC.
 CIVIL ENGINEERS • LAND SURVEYORS
 171 KAPIOLANI STREET
 HILLO, HAWAII 96720



THIS SEAL IS VALID FOR THE STATE OF HAWAII
 EXPIRES ON 12/31/2000
 IT IS VOID IF REPRODUCED OR
 COPIED IN ANY MANNER
 WITHOUT THE WRITTEN CONSENT OF
 THE BOARD OF PROFESSIONAL ENGINEERS
 OF THE STATE OF HAWAII

REVISION • DATE • DESCRIPTION

EXISTING
 JEEP ROAD REPAIRS

KTU 1ST & 2ND, S. KONA HAWAII
 TMC 3RD DIV. 8-3-04-01

SHEET TITLE
 TITLE SHEET

DWG. NO. 13-001 DRAWING NUMBER

Y0 4



POND'S CONSTRUCTION, INC.
 CIVIL ENGINEERS & ARCHITECTS
 1000 KALANANĀ'OHUE DRIVE
 HONOLULU, HAWAII 96813



THESE PLANS AND SPECIFICATIONS ARE THE PROPERTY OF POND'S CONSTRUCTION, INC. AND ARE NOT TO BE REPRODUCED OR COPIED IN ANY MANNER WITHOUT THE WRITTEN CONSENT OF POND'S CONSTRUCTION, INC.

REVISION • DATE • DESCRIPTION

**EXISTING
 JEEP ROAD REPAIR**

PROJECT: 157 & 158, S. KONA MARSH
 TOWN: 200, DIST. 4-4-48 01

SHEET TITLE
GENERAL PLAN

JOB NO. 15-158 DRAWING NUMBER
 DRAWN: DT/18/08 **C1.1**
 CHECKED BY: _____
 DATE: MAY 2014, SCALE: 1/4" = 1' OF 5'

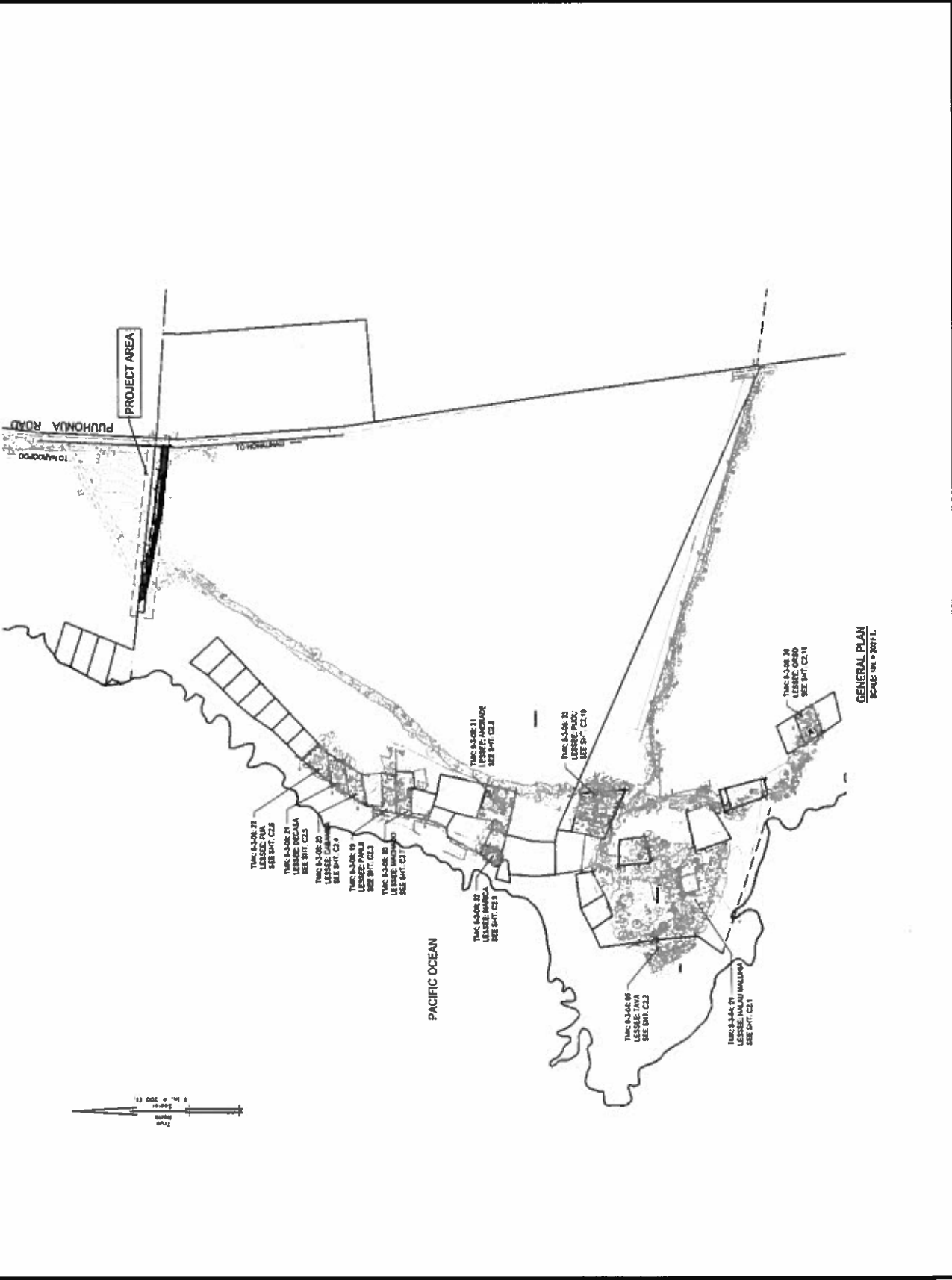

GENERAL PLAN
 SCALE: 1/4" = 100 FT.